



Pollardwater.com

THE PROFESSIONAL'S CHOICE

www.pollardwater.com

TOLL FREE 800-437-1146

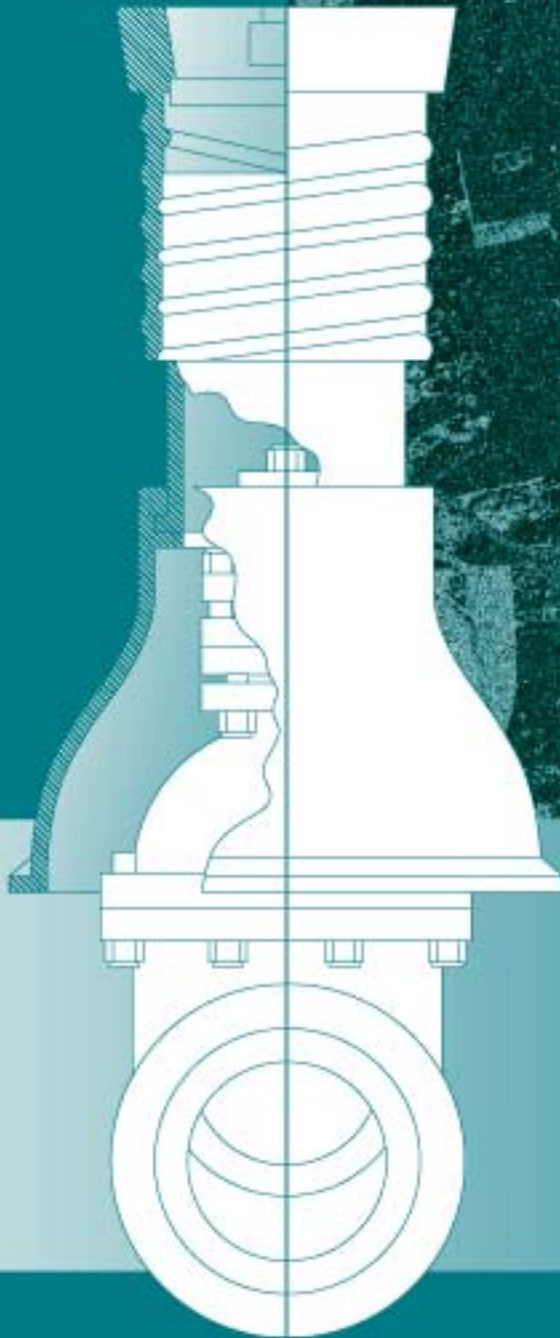

BINGHAM & TAYLOR

CAST IRON PRODUCTS

QUALITY PRODUCTS
CRAFTED WITH PRIDE
IN AMERICA



BINGHAM & TAYLOR

CAST IRON BOXES

Genuine Buffalo Style Cast Iron

2 1/2" CURB SERVICE BOXES	Page
Complete Service Boxes.....	2
Optional Top Sections.....	2
Service Box Extensions.....	2
Accessories for 2 1/2" Service Boxes	3
Stationary Rod	
Combination Key	
Pentagon Head Bolt	
Handkey	
Foot Piece	
No. 14-E Enlarged Base	
Repair Lids	3
 3" O.S. CURB SERVICE BOXES	
Complete Service Boxes.....	4
Service Box Extensions.....	4
Repair Lids.....	4
 ECLIPSE BOXES	
Complete Eclipse Boxes.....	5
Rims & Lids.....	5
 4 1/4" ROADWAY BOXES	
Complete 2-Piece Roadway Boxes.....	6
Raising Adapter.....	6
Service Box Extensions.....	6
 5 1/4" 2-PIECE VALVE BOXES	
Complete 2-Piece Boxes.....	7
Extensions	7
 5 1/4" 3-PIECE VALVE BOXES	
Complete 3-Piece Boxes.....	8
Optional Bases	8
Extensions	8
 REFERENCE TABLE	
Tables for Determining Length of 2- and 3-Piece 5 1/4" Shaft Boxes Needed.....	9

ACCESSORIES	Page
Accessories for 5 1/4" 2-Piece Valve Boxes	10
Available Lids	
Valve Extension Kit	
Locking Cover	
Rock Catcher	
Valve Operating Key	
Debris Trap	
 PAVING ADAPTERS (RISERS).....	11
Standard Adapters	
Q-Top Adapters	
Square Adapters	
Rite Hite Adapters	
P.I. Adapters	
 7" 3-PIECE VALVE BOXES	
3-Piece Screw and Sliding	
Adjustable Cast Iron Valve Boxes	12
Square Head Top Section	12
Extensions	12
Adapters	12
 ASSORTED DRIP BOXES	
Square & Round Head Drip Boxes	13
 ROADWAY BOXES	
Cast Iron Roadway Box	14
Square Head Roadway Box.....	14
Extension	14
Adapters	14
 SPECIALTY CASTINGS	
Freeze Case Caps.....	15
Hydrant Operating Nut.....	15
 CLEANOUT BOXES	
Cleanout Boxes for 4" and 6" (Lamphole)	15

2 1/2" Cast Iron Curb Service Boxes

Fig. No. 4901

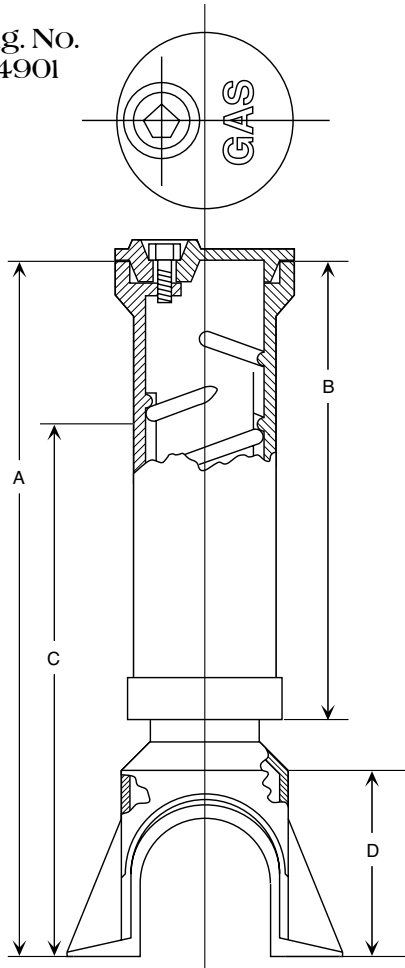

Fig. No. 4901
2 1/2" Service Boxes Complete

- We will ship Fig. No. 4901 New Style Service boxes unless specified.
- The New Style Upper Section with Inlaid Cover adds strength, and especially adapts the Box for use in cement driveways and sidewalks.
- A complete Service Box consists of Lid with Pentagon Head bolt, Top Section and Bottom Section.
- Certain sizes of these Boxes are available in Sliding Type and/or with Top Sections as shown in description below. Please inquire.

Reference Table – Dimensions in Inches, Weight in Lbs.

Size No.	Extension Range - A	Top Section & Cover			Bottom Section				Total Weight
		No.	Wt.	Dim. B	No.	Wt.	Dim. C	Dim. D	
93-D	33"-46"	D	16.1	20.0"	93	15.8	28.0"	6.5"	31.9
93-E	33"-52"	E	19.6	23.5"	93	15.8	28.0"	6.5"	35.4
94-D	40"-56"	D	16.1	20.0"	94	22.3	37.5"	6.5"	38.4
94-E	40"-60"	E	19.6	23.5"	94	22.3	37.5"	6.5"	41.9
94-F	38"-66"	F	26.1	29.0"	94	22.3	37.5"	6.5"	48.4

When Ordering Specify: Fig. No. – Size No. – Cover marked GAS or WATER or Special Lettering at Extra Cost.

Optional Top Sections

Check for size availability.

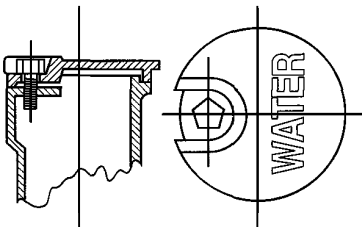

Fig. No. 4901-A
2 1/2" Old Style Top & Cover
Note Different Style Top

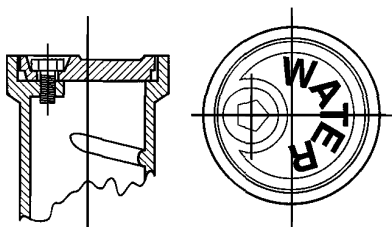

Fig. No. 4901-B
2 1/2" New Style Flush Fit Cover
Only Cover is Different Style

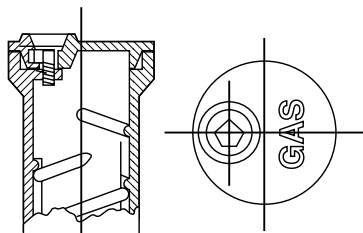

Fig. No. 4901-C
2 1/2" New Style Top & Cover

Service Box Extensions

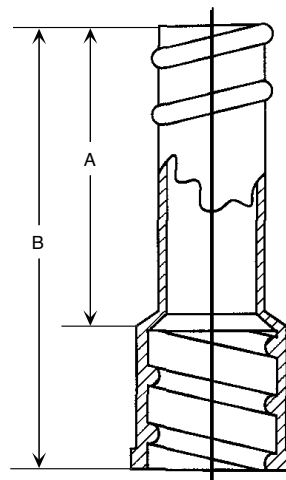

Fig. No. 4901-X

Size No.	Increases Length A	Overall Length B	Total Weight
151	9.5	13	6
152	16.5	20	8

Drawing shows Stationary Rod, Ring and Pin in Position and Complete Box resting on Foot Piece.

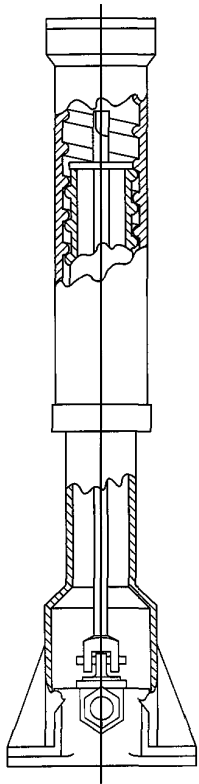

Fig. No. 4901-R

Accessories for 2 1/2" Service Boxes

- Fig. No. 4901-R
Stationary Rod, Ring & Pin
For use with all Boxes when permanent Stationary Rod is desired at installation.
- Fig. No. 4950
Combination Key
18", 27", 36", or as long as specified. This Key has 12" TEE Handle. The socket has wrench for removing Pentagon Bolt and is slotted to operate the Stationary Rod. Pick on one end.
- Fig. No. 4951, 4952, 4953 & 4954
Pentagon Head Bolt
Has Standard Waterworks Head and Thread.
- Fig. No. 4960
Hand Key
For operating Pentagon Head Bolt.
- Fig. No. 4970
Foot Piece
A Stop Cock Holder available in the following Curb Cock sizes: 3/4", 1" and 1 1/4".
- Fig. No. 4980
No. 14-E Enlarged Base
Used with complete Service Box for Curb Stops up to 2". Increases Box length 6 inches.

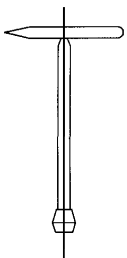

Fig. No. 4950

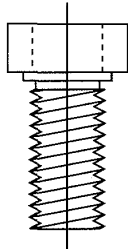

Fig. No. 4951 (Brass)
Fig. No. 4952 (Corten Steel)
Fig. No. 4953 (Aluminum)
Fig. No. 4954 (Security Bolt)

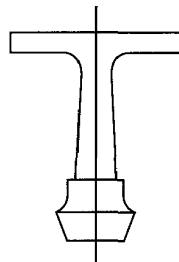

Fig. No. 4960

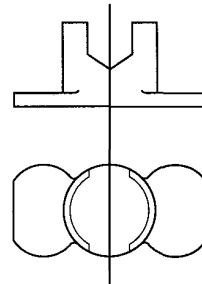

Fig. No. 4970

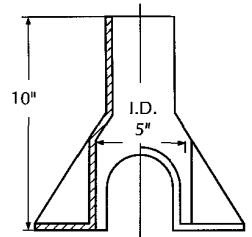

Fig. No. 4980

Repair Lids

Lettered Water or Gas as Specified

- Repair Lids are designed for use when Boxes in the ground have been damaged and it is not desirable to break the ground to replace the Lids.
- These Lids can be furnished as a substitute for our Standard Curb Box lids at a slightly higher price.

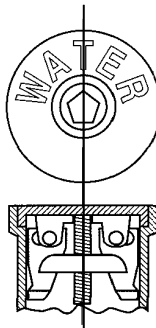

Fig. No. 4901
Flush NSR
New Style Repair Lid



Fig. No. 4901-NSR
New Style Repair Lid

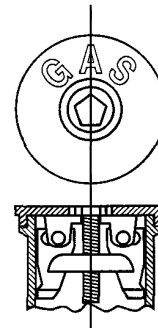

Fig. No. 4901-OSR
Old Style Repair Lid
for No. 4901-R
Service Box

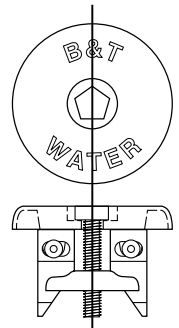

Fig. No. BTH10374
Old Style
Repair Lid

3" Shaft O.S. Curb Service Boxes

Fig. No. 4930

3" Old Style Service Box Complete

Fig. No. 4930

- We can furnish Service Boxes with 3" shaft for Services up to 1 1/2".
- Old Style only.
- Repair lids and extensions are available for this box.
- Old Style lid weighs 2.3 lbs.

Ordering Table – Dimensions in Inches, Weight in Lbs.

Size No.	Extension Range - A	Top Section & Cover			Bottom Section			Total Weight
		No.	Dim. B	Wt.	No.	Dim. B	Wt.	
2	24"-39"	9	18.0	19.6	2	23.0	14.1	32.7

When Ordering Specify: Fig. No. – Size No. – Cover marked GAS or WATER or Special Lettering at Extra Cost.

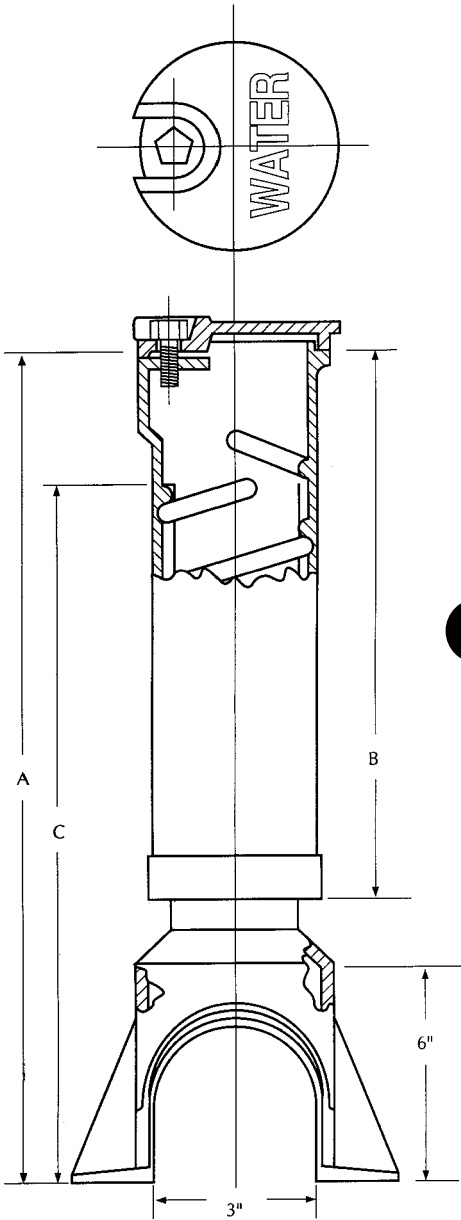

Service Box Extensions

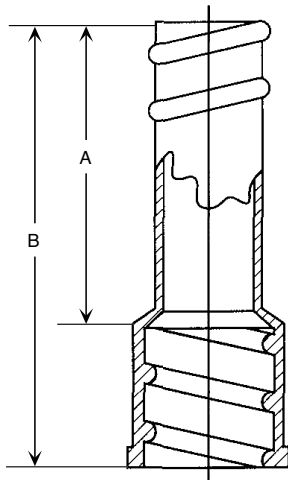

Fig. No. 4930-X

Size No.	Increases Length A	Overall Length B	Total Weight
155	20.0	22.75	13.1
156	24.0	26.75	17.7

Repair Lids

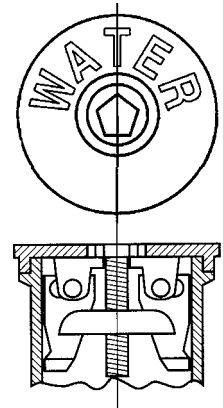

Fig. No. 4930-OSR
Old Style Repair Lid

Lettered Water or Gas
as Specified

- Repair Lids are designed for use when Boxes in the ground have been damaged and it is not desirable to break the ground to replace the Lids.
- These Lids can be furnished as a substitute for our Standard Curb Box lids at a slightly higher price.

Eclipse Boxes

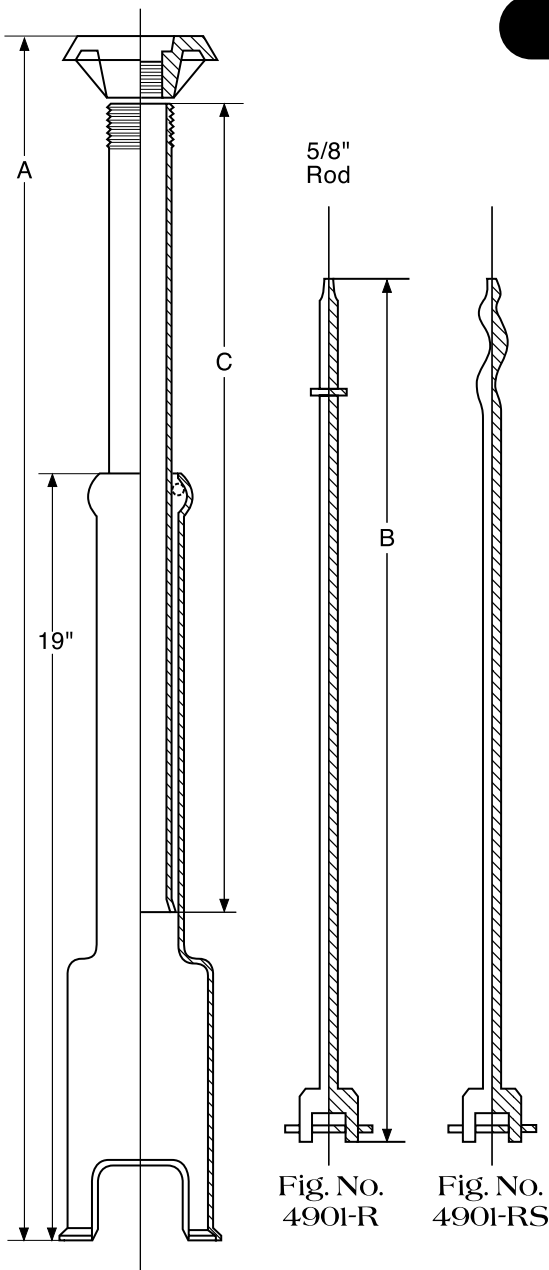
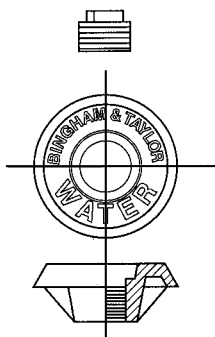
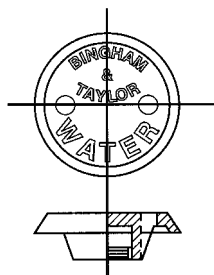

Fig. No. E-100
& E-125



Type A



Type B

Fig. No. E-100 & E-125

Eclipse Boxes Complete

- Lids are cast iron in two separate designs:
Type A — Cast iron with water works head and pentagon brass plug.
Type B — Cast iron with two 1/2" holes for operating with a straddle wrench. Has brass bushing with standard pipe thread to attach to pipe section.
- Steel Pipe Shaft available in 1" or 1 1/4" is adjustable up and down and held in place by a brass ring. Type A available in 1" and 1 1/4" pipe size. Type B available in 1" pipe size only.
- Bottom is cast iron. It is belled and arched to fit curb stops.
- The permanent steel rod is forged at the top end to receive a short cut-off wrench. The rod is welded to the cut-off key at the bottom. A connecting pin is provided to attach the key to the valve tee. Two rods available: straight rod with centering ring (4901-R) or curved rod (4901-RS).
- Complete curb box consists of lid, top pipe, cast iron bottom, and rod assembly (rod, ring and pin).
- All Eclipse Boxes have 12" range of extension.
- 5/8" Steel Rod. 1" and 1 1/4" Steel Pipe.
- 1/2" Stainless Steel Rods available.

When Ordering Specify: Fig. No. – Size No. – Cover marked
GAS or WATER or Special Lettering at Extra Cost.

Size Dim. A	Rod Dim. A	Pipe Dim. C	Weight
1.5-2.5	16.75	11	15.0
2.0-3.0	21.00	17	16.0
2.5-3.5	27.00	23	16.5
3.0-4.0	33.00	29	17.0
3.5-4.5	39.00	35	18.0
4.0-5.0	45.00	41	19.0
4.5-5.5	51.00	47	20.0
5.0-6.0	57.00	53	21.0
5.5-6.5	63.00	59	22.0
6.0-7.0	69.00	65	23.0
6.5-7.5	75.00	71	24.0
7.0-8.0	81.00	77	25.0

Size Dim. A	Rod Dim. A	Pipe Dim. C	Weight
1.5-2.5	16.75	13	15.0
2.0-3.0	21.00	19	16.0
2.5-3.5	27.00	25	16.5
3.0-4.0	33.00	33	17.0
3.5-4.5	39.00	37	18.0
4.0-5.0	45.00	43	19.0
4.5-5.5	51.00	49	20.0
5.0-6.0	57.00	55	21.0
5.5-6.5	63.00	61	22.0
6.0-7.0	69.00	67	23.0
6.5-7.5	75.00	73	24.0
7.0-8.0	81.00	79	25.0

4 1/4" Shaft Round Head Roadway Boxes

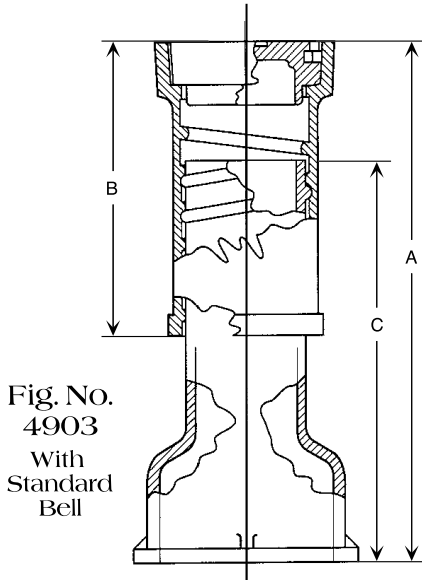

Fig. No. 4903
With
Standard
Bell

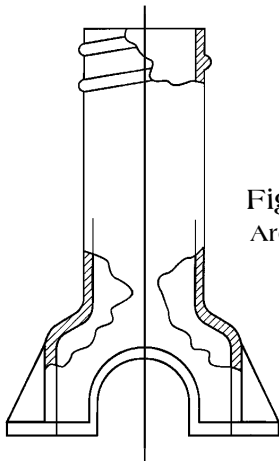

Fig. No. 4903
Arched Bottom

Fig. No. 4903

4 1/4" Shaft 2-Piece Roadway Boxes

- This Box is designed for use both in the roadway and behind the curb for Valves up to 3 inches in size and large Stop Cocks.
- Standard Covers are lettered WATER or GAS. Special Lettering available at Extra Cost.
- Locking covers available, lettered WATER or GAS. Special Lettering available at extra cost.
- Certain sizes available in Sliding Type.
- Certain sizes available in Closed Bell Bottom covering the operating nut of small valves.
- Certain sizes available with Square Head Top Section and Risers.

Ordering Table – Dimensions in Inches, Weight in Lbs.

Size No.	Extension Range - A	Top Section & Cover			Bottom Section			Total Weight
		No.	Dim. B	Wt.	No.	Dim. B	Wt.	
140-Q	18"-24"	Q	12.0	25.4	140	14.75	16.0	41.4
141-Q	22"-28"	Q	12.0	25.4	141	18.00	23.0	48.4
142-Q	24"-30"	Q	12.0	25.4	142	21.75	29.0	54.4
142-R	27"-39"	R	20.5	41.0	142	21.75	29.0	70.0
143-R	34"-48"	R	20.5	41.0	143	30.50	33.0	74.0
144-R	39"-54"	R	20.5	41.0	144	36.25	35.0	76.0
144-RR	39"-60"	RR	26.0	45.0	144	36.25	35.0	80.0

Raising Adapter

Fig. No. 4903-A, -B, -C
Raising Adapter

- Used when repaving requires additional height to existing Box.
- Uses existing Cover or special Non-Tip Cover with longer skirt – one size.
- Three Models:
 - 1 3/4" Raise Only (Fig. No. 4903-A)
 - 1 3/4"-8" Raise (Fig. No. 4903-B)
 - 1" Raise (Fig. No. 4903-C)

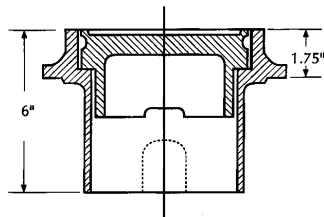

Fig. No. 4903-A

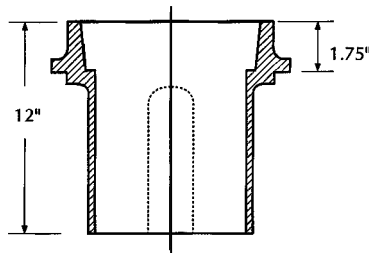

Fig. No. 4903-B

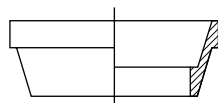

Fig. No. 4903-C

Service Box Extension

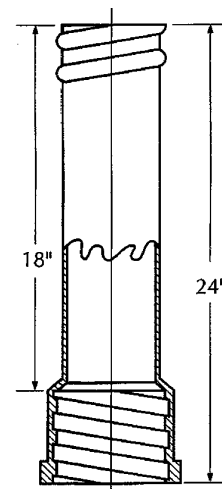

Fig. No. 4903-X

Fig. No. 4903-X
No. 49
Extension
Section

- Extends Boxes shown above up to 18 inches.
- Weight: 20 pounds.

5 1/4" Shaft 2-Piece Valve Boxes

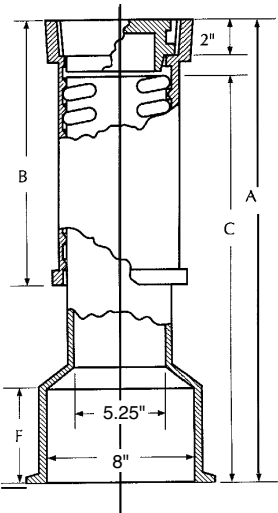

Fig. No. 4905
2-Piece
Screw Type
Adjustable
Valve Box

- Designed to cover the Stuffing box only on Valves up to 10" in size.
- Square Screw Type Top available 15" and 26 1/2" length.
- Locking Covers available.

Fig. No. 4905

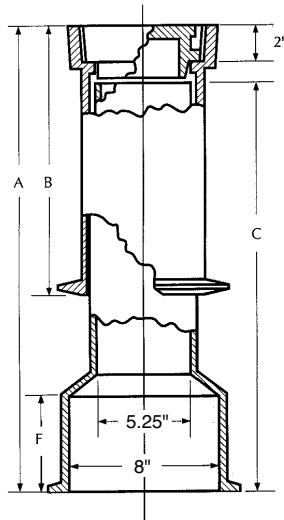

Fig. No. 4908
2-Piece Sliding Type
Adjustable Valve Box

- This Box is the same as the one at left, except it is Sliding Type.
- Some feel the Sliding feature helps prevent impact to valve from Surface.
- Flange at bottom of Top Section can be any distance from top or omitted.
- Locking Covers available.

Fig. No. 4908

Cover marked GAS or WATER or Special Lettering at Extra Cost. Cover weight - 13 lbs.

Size No.	Extension Range - A	Top Section & Cover No.	Dim. B	Wt.	Bottom Section No.	Dim. B	Wt.	Height Bell-F	Wt.
18	18-24	54	10.5	35.0	61	14.5	23.0	6.5	58.0
20	27-36	55	15.0	42.0	62	24.0	31.5	6.5	73.5
21	39-48	55	15.0	42.0	64	36.0	46.0	8.5	88.0
22	39-60	56	26.0	70.0	64	36.0	46.0	8.5	104.0

Longer Boxes made by adding Extensions to Size No. 22.

Size No.	Extension Range - A	Top Section & Cover No.	Dim. B	Wt.	Bottom Section No.	Dim. B	Wt.	Height Bell-F	Wt.
5461-S	18-24	54-S	10.5	35.0	61-S	15.0	24.0	6.5	59.0
5561-S	23-29	55-S	15.5	42.0	61-S	15.0	24.0	6.5	65.1
5562-S	27-36	55-S	15.5	42.0	62-S	24.5	33.0	6.5	75.0
5564-S	39-48	55-S	15.5	42.0	64-S	36.0	46.0	8.5	88.0
5662-S	38-48	56-S	26.5	57.0	62-S	24.5	33.0	6.5	90.0
5664-S	39-60	56-S	26.5	57.0	64-S	36.0	46.0	8.5	103.0

Longer Boxes made by adding Extensions to Size No. 5664-S.

See Table on page 9 for proper length of box for various valves.

Extensions

Fig. No. 4905-X

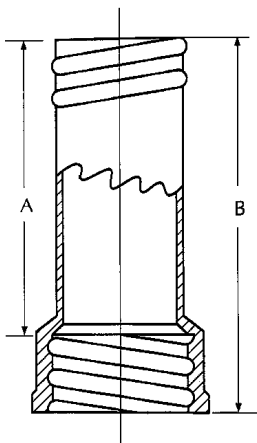

Fig. No. 4905-X
Screw Extension

Size No.	Increases Length A	Overall Length B	Wt.
57	9.0	13.0	20.0
58	14.0	18.0	23.0
59	20.0	24.0	31.5
60	24.0	30.0	36.5
61	30.0	36.0	46.0

Fig. No. 4908-X

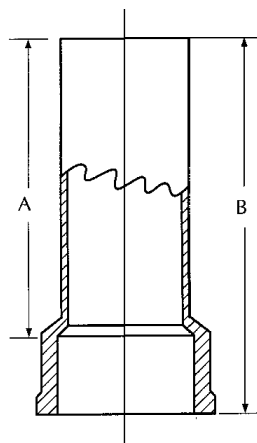

Fig. No. 4908-X
Sliding Extension

Size No.	Increases Length A	Overall Length B	Wt.
63-E	9.0	13.0	20.0
64-E	14.0	18.0	23.0
65-E	20.0	24.0	31.5
66-E	24.0	30.0	36.5
67-E	30.0	36.0	46.0

5 1/4" Shaft 3-Piece Valve Boxes

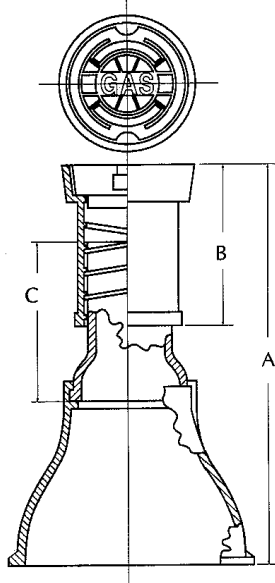

Fig. No. 4906

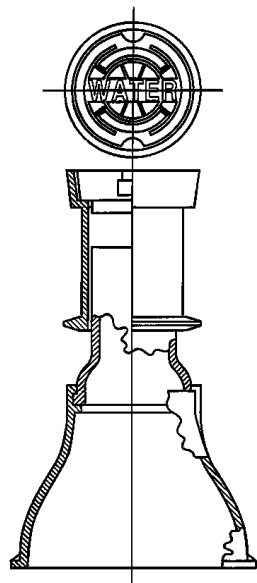

Fig. No. 4907

Fig. No. 4906, 4907

3-Piece Screw & Sliding Type Valve Boxes

- Valve Boxes are designed to cover the Valve completely. See Page 9.
- The Top Section screws or slides over the Middle Section to provide adjustment. The Middle Section locks into the Base Section.
- The No. 6 Base is the Standard Base used to determine lengths shown in Table on Page 9. All pricing considers the No. 6 Base only. Other Bases will reflect a change in complete Box price and total length.
- See Page 11 for Paving Adapters to raise our Valve Boxes.
- Locking covers available.
- Square Screw Type Top available in 15" and 26 1/2" length.
- Longer boxes can be furnished by adding extensions. See below.

Cover marked GAS or WATER. Special Lettering at Extra Cost.
Cover weight - 13 lbs. See Table on Page 9 for lengths and sizes.

Size No.	Extension Range - A	Top Section & Cover			Bottom Section			No. 6 Base Wt.	Total Wt.
		No.	Dim. B	Wt.	No.	Dim. B	Wt.		
AAA	17" Stat	57	6.0	32.5				45.0	77.5
AA	22"-28"	54	10.5	35.0	60	10.5	14.0	45.0	94.0
A	28"-40"	55	15.5	42.0	61	16.0	23.0	45.0	110.0
B	36"-48"	55	15.5	42.0	62	24.0	31.5	45.0	118.5
C	42"-54"	55	15.5	42.0	63	30.0	36.5	45.0	123.5
CC	48"-60"	55	15.5	42.0	64	36.0	46.0	45.0	133.0
D	42"-66"	56	26.5	58.0	63	30.0	36.5	45.0	139.5
E	48"-72"	56	26.5	58.0	64	36.0	46.0	45.0	149.0

Optional Bases

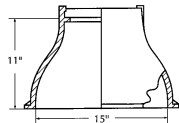

Fig. No. 4909-A
No. 6 Round Base

- For Valves 8" and smaller.
- Weight — 45 lbs.

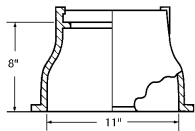

Fig. No. 4909-B
No. 4 Dome Base

- For Valves 4" and smaller.
- Overall length of Valve Box in Table will be 3" less.
- Weight — 30 lbs.

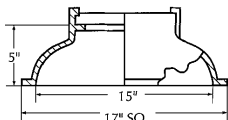

Fig. No. 4909-C
No. 140 Round Base

- 17" Square Flange for Valves near surface & up to 24".
- Overall length of Valve Box in Table will be 6" less.
- Weight — 30 lbs.

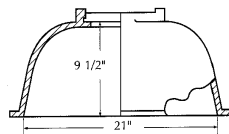

Fig. No. 4909-D
No. 160 Oval Base

- For Valves 16" and smaller.
- Overall length of Valve Box in Table will be 1 1/2" less.
- Weight — 56 lbs.

Fig. No. 4909-E (Not Shown)
No. 8 Round Base

- For 12" Valves and smaller.
- Same as No. 6 Round Base (shown at left), only 12" high and 17" I.D. at bottom.
- Weight 50 lbs.

Extensions

Fig. No. 4905-X
Screw Extension

Size No.	Increases Length A	Overall Length B	Wt.
57	9.0	13.0	20.0
58	14.0	18.0	23.0
59	20.0	24.0	31.5
60	24.0	30.0	36.5
61	30.0	36.0	46.0

Fig. No. 4905-X

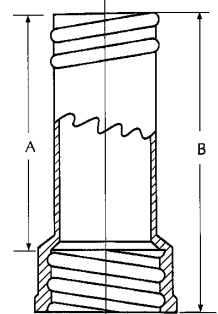
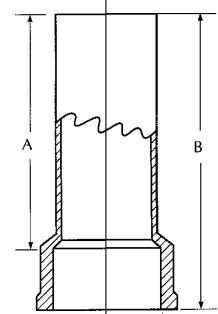

Fig. No. 4908-X
Sliding Extension

Size No.	Increases Length A	Overall Length B	Wt.
63-E	9.0	13.0	20.0
64-E	14.0	18.0	23.0
65-E	20.0	24.0	31.5
66-E	24.0	30.0	36.5
67-E	30.0	36.0	46.0

Fig. No. 4908-X



5 1/4" Shaft 2- & 3-Piece Valve Boxes

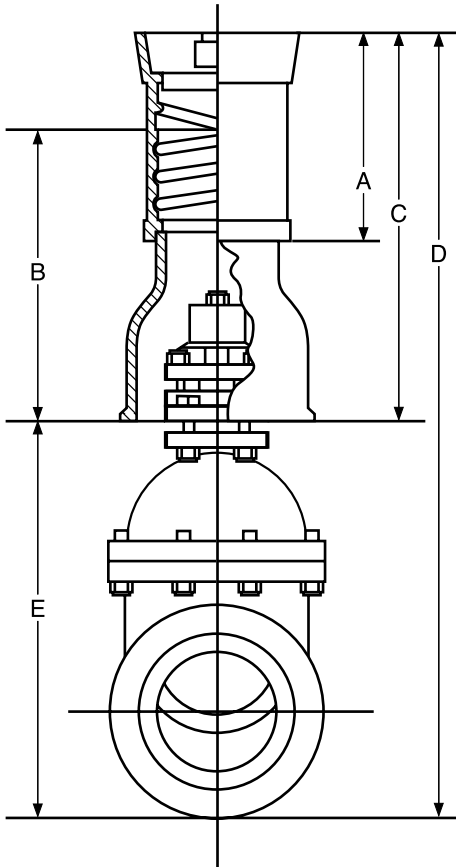

Table for Determining Length of 2-Piece Box Needed
5 1/4" Shaft 2-Piece Boxes

Page 7 (Pictured left, top)

Size of Valve	3"	4"	5"	6"	8"	10"
Inches from bottom lower section to bottom trench — E	10"	12"	14"	16"	21"	25"

To determine length box to order on Page 7 (Dim. C), use depth of trench (Dim. D) and deduct inches shown in table above (Dim. E).

EXAMPLE: For 6" Valve in 5 foot trench.

Depth of trench	60"
For 6" Valve deduct	- 16"
Min. Length Box	44"

See Page 7 — Order No. 21 or 5564-S (36"-48")

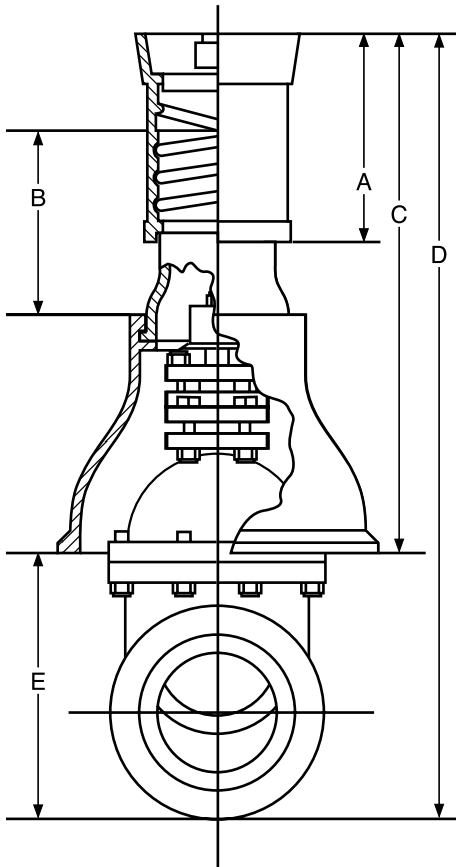

Table for Determining Length of 3-Piece Box Needed
5 1/4" Shaft 3-Piece Boxes

Page 8 (Pictured left, bottom)

Size of Valve	Bottom Base to Bottom Trench (Dim. E)	No. Base Used	Depth of Trench (Dim. D)									
			36"	42"	48"	54"	60"	66"	72"	78"	84"	
3	8"	4	A	B	C	CC	D	E	F*	F*	G	
4	12 1/2"	4	A	A	B	C	CC	D	E	F*	F*	
6	15"	6	AA	A	A	B	C	CC	D	E	F*	
8	19"	6	AA	A	A	B	B	C	CC	D	E	
10	24"	6		AA	A	A	B	B	C	CC	D	
12	31"	160			AAA	A	A	B	B	C	CC	
14	36 1/2"	160				AA	A	A	B	B	C	
16	41 1/4"	160					AA	AA	A	B	C	

* The longest box we manufacture is the "E" Valve Box. In order to furnish "F", "G" and longer Boxes, we will add Extension Sections to the "E".

For Valves close to surface, use No. 140 Base shown on page 8 and reduce length shown above 6 inches.

5 1/4" Shaft Valve Box Lids

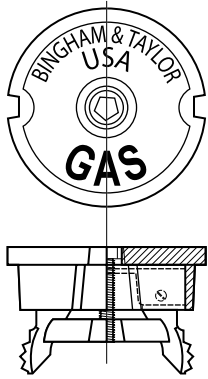

Fig. No. 4904-CI
Locking
Cover

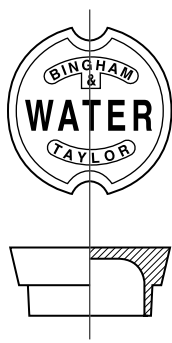

Fig. No. 4905-L1.5
Standard
Round
Drop-In Lid

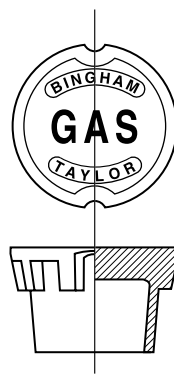

Fig. No. 4905-L2.5
Round
Drop-In Lid
With 2 1/2" Skirt

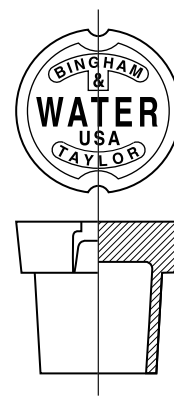

Fig. No. 4905-L4
Round
Drop-In Lid
With 4" Skirt

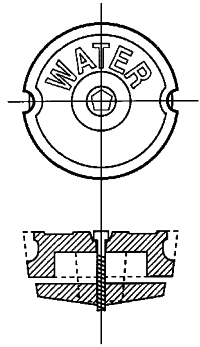

Fig. No. 4904-L
Locking
Cover

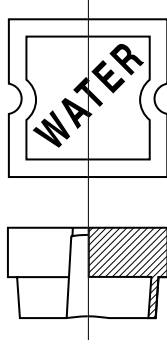

Fig. No. 4905-SQ-L1.5
Square
Drop-In Lid
With 1 1/2" Skirt

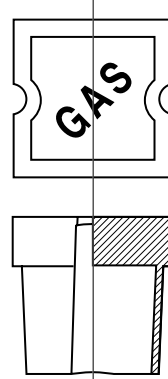

Fig. No. 4905-SQ-L4
Square
Drop-In Lid
With 4" Skirt

Lids available in Gas, Water & Sewer.
Special markings on lids are available.

Please inquire.

Figure No. #	Skirt Size	Weight
4904-L	N/A	11 lbs.
4905-L1.5	1 1/2"	13 lbs.
4905-L2.5	2 1/2"	14.5 lbs.
4905-L4	4"	25 lbs.
4905-SQ-L1.5	1 1/2"	14 lbs.
4905-SQ-L4	4"	25 lbs.

Accessories for 5 1/4" 2-Piece Valve Boxes

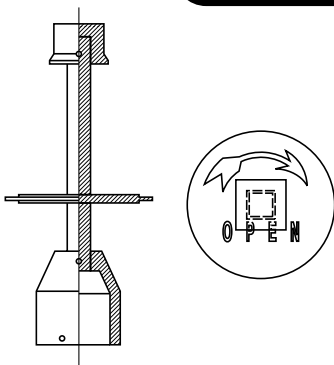

Fig. No. 5051
Valve Stem
Extension Kit

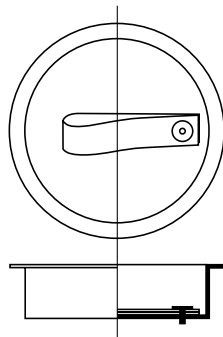

Fig. No. 5052
Debris
Trap

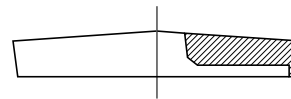

Fig. No. 5060
Rock
Catcher

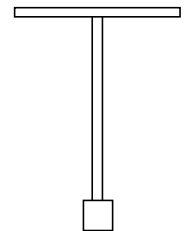

Fig. No. 5050
Valve
Operating Key

Paving Adapters (Risers) for 5 1/4" Shaft Boxes

Fig. No. 6016-B

Standard Adapters

- For use in raising our 5 1/4" Shaft Buffalo Type Valve Boxes.
- Cover — 13 lbs.
- **Note:** 1 1/2" and 2" Adapters available with flange.

Figure No.	Size	Weight
6016-B	1"	6.0
6016-B	1 1/2"	10.0
6016-B	2"	11.5
6016-B	2 1/2"	14.0
6016-B	3"	16.0
6016-B	4"	21.0

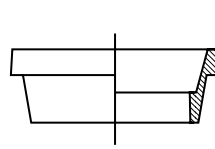

Fig. No. 6016-B
1" Adapter

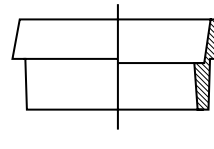

Fig. No. 6016-B
1 1/2" Adapter

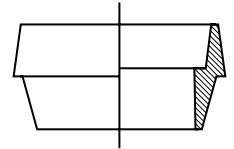

Fig. No. 6016-B
2" Adapter

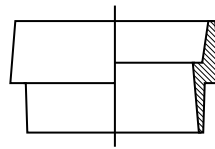

Fig. No. 6016-B
2 1/2" Adapter

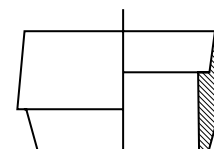

Fig. No. 6016-B
3" Adapter

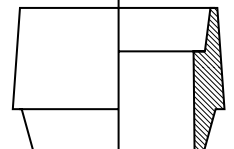

Fig. No. 6016-B
4" Adapter

When Ordering Specify Fig. No. – Type – Raise desired

Fig. No. 6010

Q-Top Adapter

- This Adapter can raise any height from 0"-10".
- Requires special lid.
- Weight — 18 lbs.
- Cover — 9 lbs.

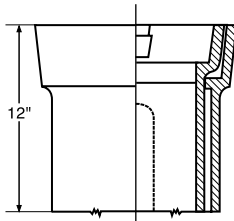

Fig. No. 6010

Fig. No. 6017

P.I. Adapter

- For use with 6" cast iron or plastic pipe to make up a Valve Box. Uses standard 5 1/4" Valve Box Cover.
- Weight — 17 lbs.

NOT FOR SCHEDULE 40

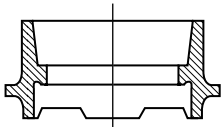

Fig. No. 6017

Fig. No. 6016-SQ

Square Adapters

- For use in raising our 5 1/4" Square Valve Boxes.

Figure No.	Size	Weight
6016-SQ	1 1/4"	10
6016-SQ	2 1/4"	14

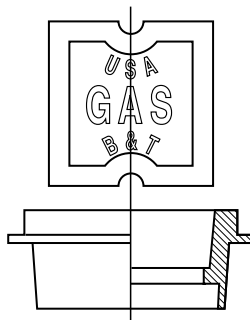

(Requires special lid.)

Fig. No. 6016-SQ
1 1/4" Square Adapter

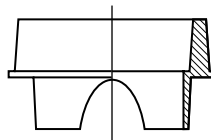

(Uses original lid.)

Fig. No. 6016-SQ
2 1/4" Square Adapter

Fig. No. 6020, 6030

Rite Hite Adapter

- When repaving, this Adapter can be used when existing Valve Box is set too high or too low.
- Adjustable from 2 1/2" to 12". Uses existing Box Cover.

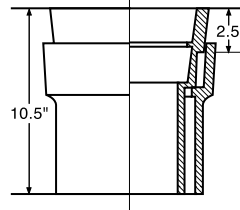
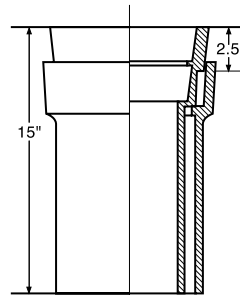

Fig. No. 6020
Sliding Type
15" or 10.5"

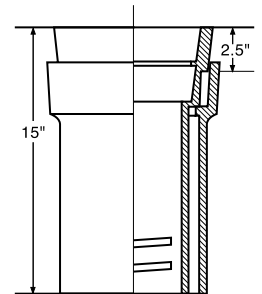

Fig. No. 6030
Screw Type
15"

Figure No.	Length	Weight
6020 SlidingType	10.5"	15
6020 Sliding Type	15"	22
6030 Screw Type	15"	26

7" Shaft 3-Piece Valve Boxes

Fig. No. 5001

Fig. No. 5001

3-Piece Screw or Sliding Type Adjustable Cast Iron Valve Box

- The Top screws over the Middle Section to provide adjustment. The Middle Section locks into Base Section.
- Fig. No. 4909-A, No. 6 Base is standard in our order table below to determine lengths and price. Other bases reflect a change in length of complete box. See Page 8.
- Certain sizes can be furnished with Square Head Top Section (below).
- Please specify WATER or GAS on Cover. Other Lettering available at Extra Cost.
- Locking Covers are available at extra cost.
- Paving Adapters are available for these Boxes. See below.
- No. 74 Square Top available.

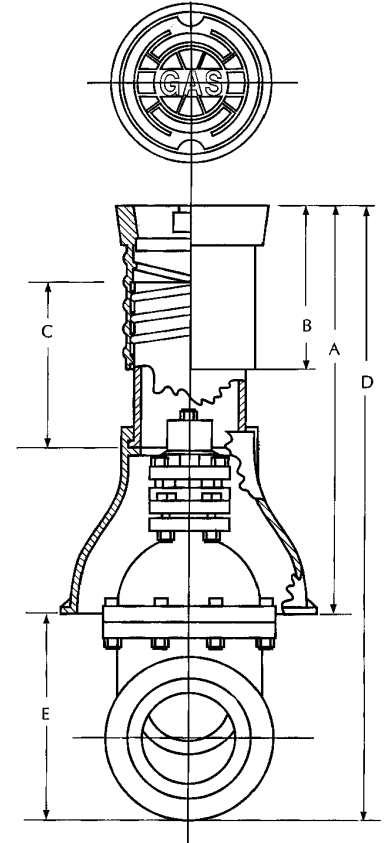

Size No.	Extension Range - A	Top Section & Cover		Bottom Section			No. 6 Base Wt.	Total Wt.	
		No.	Dim. B	No.	Dim. B	Wt.			
II	21"-27"	74	9.00	58.5	80	8.00	14.0	45.0	117.50
I	27"-39"	75	15.25	81.5	81	14.00	24.5	45.0	151.00
J	33"-45"	75	15.25	81.5	82	20.00	30.0	45.0	156.50
K	39"-51"	75	15.25	81.5	83	26.25	41.0	45.0	167.50
L	39"-60"	76	26.00	111.0	83	26.25	41.0	45.0	197.00

* Longer Boxes made by adding extensions to size L. For Valve closer to surface, use No. 140 Base shown on Page 8 and reduce length shown above by 6 inches.

Table for Determining Length of Box Needed

Size of Valve	Bottom Base to Bottom Trench (Dim. E)	No. Base Used	Depth of Trench (Dim. D)									
			36"	42"	48"	54"	60"	66"	72"	78"	84"	
3	8"	4	II	I	J	K	L	L	L*	L*	O*	
4	13 1/2"	4	II	I	J	J	K	L	L	L*	L*	
6	15"	6	II	II	J	J	J	K	L	L*	L*	
8	19"	6		II	I	J	J	K	L	L	L*	
10	24"	6			II	I	I	K	K	L	L	
12	31"	160				II	I	J	K	K	L	
14	36 1/2"	160					II	I	J	J	K	
16	41 1/4"	160						II	I	I	J	

*See Note concerning longer Boxes beneath table for Fig. 5001 above.

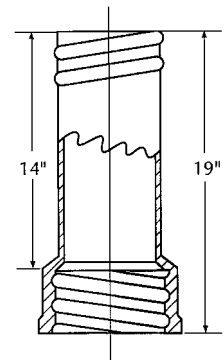

Fig. No. 5001-X
No. 71 Extension Section

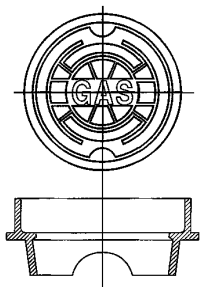

Fig. No. 5040
7" Round Adapter
2 1/4" Raise Only

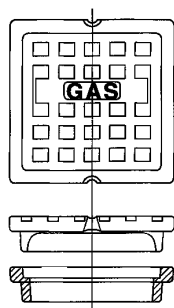

Fig. No. 6007-A
7" Square Adapter 1"

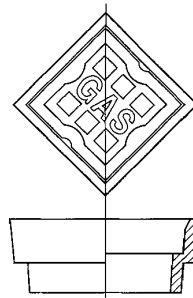

Fig. No. 6007-B
7" Square Adapter 2 1/2"

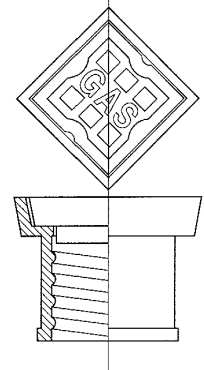

Fig. No. 5020
Square Head Top Section

Assorted Drip Boxes

Fig. No. 6004
No. 106 Drip Box

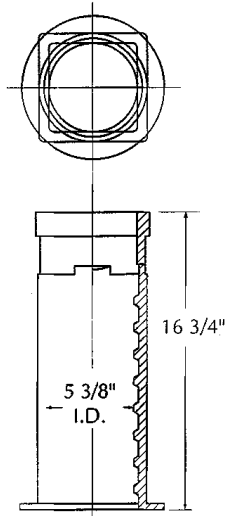

Fig. No. 6005
#55 Drip Box

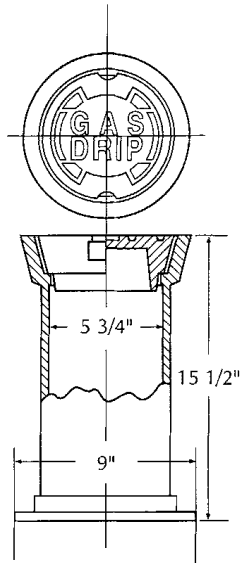

Fig. No. 6007
Square Head Drip Box

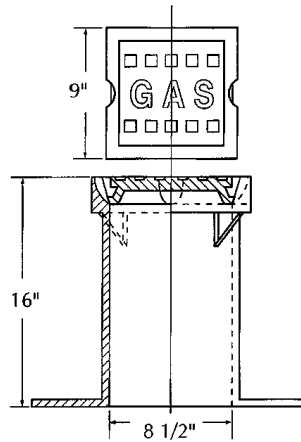

Fig. No. 6008
No. 48 Drip Box

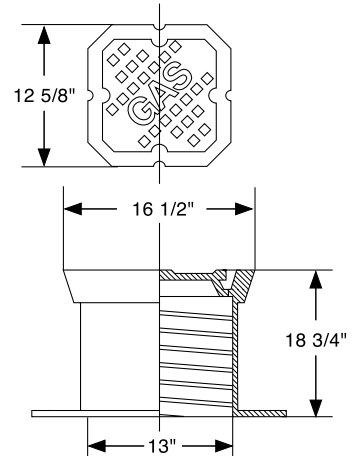

Fig. No. 6004-No. 106

Square Head Drip Box

- Cover lettered GAS or GAS DRIP.
- Adapters available.
- Weight 35 lbs.

Fig. No. 6005-No. 55

Round Head Drip Box

- Can be furnished with Square Head instead of Round Head.
- Cover lettered GAS or GAS DRIP.
- Adapters shown on Page 11.
- Round Wt. 45 lbs., Square Wt. 39 lbs.

Fig. No. 6007-No. 178

Square Head Drip Box

- Letter GAS unless otherwise specified.
- 14" Square Flange at bottom.
- Total Weight - 99 lbs.
- Fig. No. 6007-1" Raise, 6007-2 1/2" Raise. 1" uses Special Lid; 2 1/2" uses existing Lid. See Page 11.
- Adapters available.

Fig. No. 6008-No. 48

Drip Box

- Cover GAS, adapters available.
- Total Weight - 188 lbs.
- 2" Round Flange at bottom.

Roadway Boxes

Fig. No. 6050
#199 Roadway Box

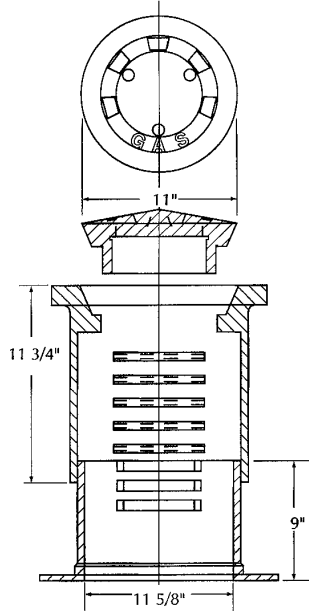

Fig. No. 6050

#199 Cast Iron Roadway Box

- Octagonal Head Roadway Box with round convex lid.
- Convex lid is extra heavy and designed to prevent lid from dislodging in extreme traffic conditions.
- Threads are drop-turn for height adjustment.
- This is an extra heavy box to withstand extreme conditions.
- Extension range: 10" to 18".

Paving Adapters Available.

Fig. No. 6012
Square Head Valve Box

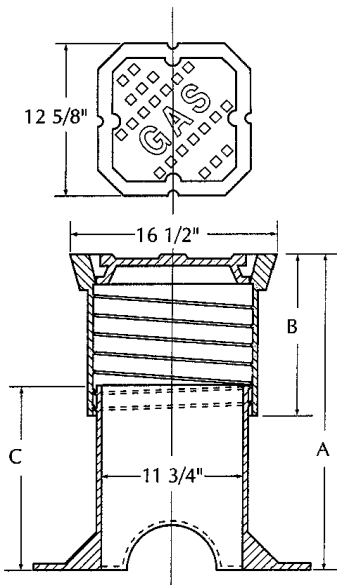

Fig. No. 6012
Square Head
Valve Box

- Extra large 12" Round Shaft Screw Type adjustable.

Fig. No. 6012-X
No. 100
Extension

- Available to extend Box 12". Weight - 50lbs.

Fig. No. 6012-A
1" Raise - 55 lbs.
1 1/2" Raise - 67 lbs.
Special Cover - 27 lbs.

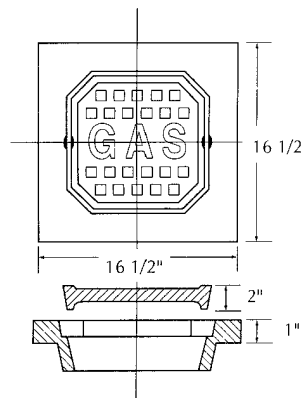

Fig. No. 6012-B
2 1/2" Raise - 95 lbs.
Cover - 40 lbs.
Use Cover from Existing Box.

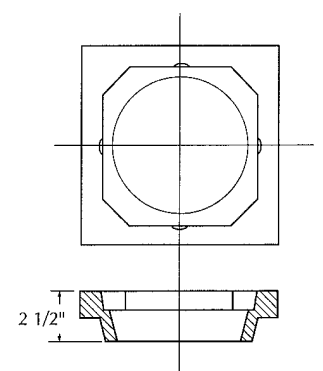

Table for Ordering

Size No.	Extension Range - A	Top Section & Cover		Top Section & Cover		Total Wt.
		Wt.	Dim. B	Wt.	Dim. C	
200	18"-26"	145	13	66	15 1/4	211
201	24"-37"	173	18 3/4	77	21 1/4	250

Fig. No. 6012-A & 6012-B
Adapters

- For raising Box 1", 1 1/2" and 2 1/2".

Specialty Castings

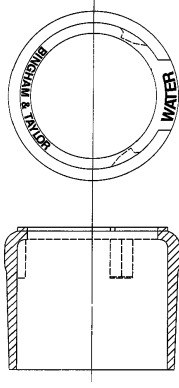

Fig. No. FCC-4
4" Freeze Case Cap
Weight - 25.5 lbs.

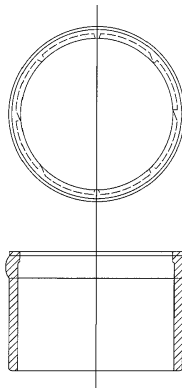

Fig. No. FCC-6
6" Freeze Case Cap
Weight - 34 lbs.

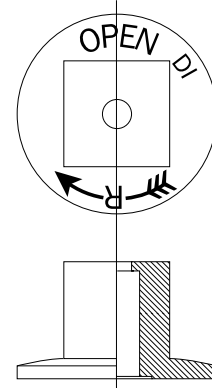

Fig. No. HON-01
Hydrant Operating Nut
Weight - 2 lbs.

Fig. No. FCC-4 & FCC-6 Freeze Case Caps

- For use with Wood-Mathews Hydrants and Insert Replacements from Clow, Kennedy and Mueller (K81AW)
- Plastic Freeze Casings also available upon request.
- Available in 4" and 6" sizes.

Fig. No. HON-01 Hydrant Operating Nut

- 4" Ductile Iron - HON - Size 3/4"
- 6" Ductile Iron - HON - Size 7/8"
- 8" Ductile Iron - HON - Size 1"
- 12" Ductile Iron - HON - Size 1 1/4"

Cleanout Boxes

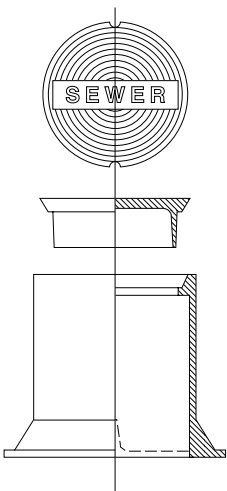

Fig. No. 107
Cleanout Cover
for 4" Cleanouts

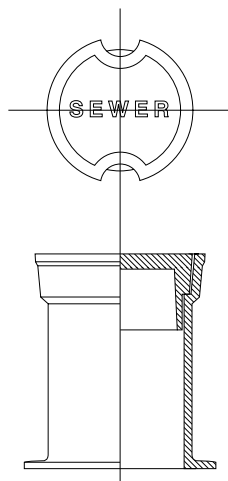
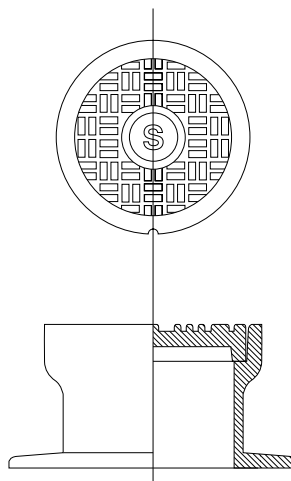

Fig. No. 8250
Cleanout Cover
for 4" Cleanouts



Cleanout
(Lamphole)
Cover for 6" Cleanouts

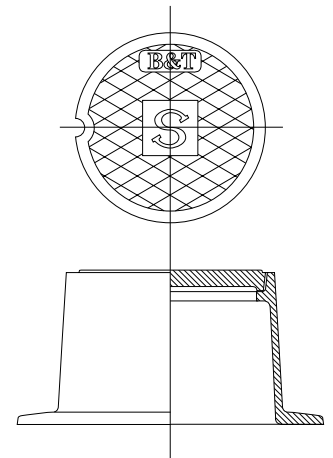

Fig. No. BT1975
Cleanout Box

- Cover Weight - 11 lbs.
- Box Weight - 29 lbs.

- Cover Weight - 13 lbs.
- Box Weight - 21 lbs.

- Cover Weight - 20 lbs.
- Box Weight - 62 lbs.

- Lids available in 3 styles:
BT1975L plain
BT1975LS has an "S"
BT1975W has a "W"
- Cover Weight - 15 lbs.
Box Weight - 44 lbs.



BINGHAM & TAYLOR

Limited Warranty Statement

Seller will replace or repair, at the option of Seller, free of charge, any product which has failed in normal use and service within 90 days of date of passage of title to Buyer due to defects in material or workmanship. Seller must be given prompt written notice of such failure, and the product must be returned to Seller.

The provisions of this warranty shall not apply to any product which has not been properly installed, or subjected to misuse, negligence or accident or which shall have been repaired or altered in any way so as, in the judgement of Seller, to affect adversely its performance and reliability nor to any product which is used for a purpose for which it is not designed.

THIS WARRANTY TO REPLACE OR REPAIR DEFECTIVE PRODUCTS IS BUYER'S EXCLUSIVE REMEDY AND IS EXPRESSLY IN LIEU OF AND IS HEREBY IN DISCLAIMER OF ANY IMPLIED WARRANTIES OR MERCHANTABILITY AND FITNESS FOR A PARTICULAR PURPOSE AS WELL AS ALL OTHER IMPLIED WARRANTIES, IN LAW OR EQUITY, AND OF ALL OTHER OBLIGATIONS OR LIABILITIES ON SELLER'S PART. SELLER'S AGREEMENT HEREUNDER RUNS ONLY TO BUYER AND DOES NOT EXTEND EXPRESSLY OR BY IMPLICATION TO ANY OTHER PERSON. IN NO EVENT SHALL SELLER BE LIABLE FOR INCIDENTAL OR CONSEQUENTIAL DAMAGES, LOSS OF ANTICIPATED PROFITS OR OTHER ECONOMIC LOSS.

In the event that the other remedies fail of their essential purpose, Buyer's sole and exclusive remedy shall be, upon return of the goods, the refund of whatever portion of the purchase price has been paid.

TERMINATION

Seller may, at its option, terminate this agreement whenever Buyer shall fail to comply with any of the provisions hereof.

BINGHAM & TAYLOR

The Bingham & Taylor family of employees is dedicated to providing you, our customers, with the highest quality products, support and service to successfully satisfy your requirements.

Our service is fast and dependable, our prices are competitive and reasonable.

We have been in continuous business since 1849 serving water and gas industries.

Associate member of the American Water Works Association since 1882, member of the Water and Wastewater Equipment Manufacturers Association, Inc., and associated member of the American Gas Association.

In order for us to quote delivered prices on any specified type and quantity of the valve boxes shown in this catalog, the following information is necessary:

1. Shipping destination.
2. Trench depth (surface to bottom of trench), bury (surface to top of pipe), or the minimum and maximum adjustment length that will serve.
3. Quantity of each size.
4. Size of valve box shown in this catalog, (2 1/2, 4 1/4, 5 1/4) Shaft, Etc.
5. Type of box desired, screw or sliding type, 2 piece or 3 piece.
6. Size of base required or size of valve you will cover.

The table on the page showing the type of boxes we furnish will assist you in acquiring this information. Also, we will be glad to help in any way to arrive at your requirements.

All Shipments are made F.O.B. Shipping Point

LOSS, DAMAGE AND OVERCHARGES

Consignee is responsible and must be particular about reporting all claims promptly when shipments arrive. All exceptions must be noted on the freight delivery receipt bills and endorsed by the delivering freight agent at time of arrival and the noted delivery receipts must accompany the claim. Careful compliance with the above procedure will insure prompt adjustments of claims.