



# OWNER'S MANUAL

## MicroTSCM

### Streaming Current Monitor

**Pollardwater** dot com

Phone 800-437-1146  
Fax 425-861-7235  
[info@pollardwater.com](mailto:info@pollardwater.com)

**West Coast Branch**  
17515 NE 67<sup>th</sup> Ct  
Redmond, WA 98052

**East Coast Branch**  
200 Atlantic Ave  
New Hyde Park, NY 11040

21648 (03/06)  
REV 2.1

## Table of Contents

Section	Page
<b>Specifications</b> .....	1
<b>1.0 Overview</b> .....	2
1.1 Unpacking and Inspection of the Instrument and Accessories .....	2
<b>2.0 Safety</b> .....	2
2.1 Symbols Used In the MicroTSCM.....	2
<b>3.0 Theory of Operation</b> .....	3
3.1 Treatment of Water for Clarification.....	4
3.2 Charge Analysis .....	5
<b>4.0 Installation and Commissioning</b> .....	6
4.1 Sample Point .....	6
4.2 Flow Rate .....	6
4.3 Sensor Mounting & Plumbing .....	7
4.4 Analyzer Mounting.....	8
4.5 Electrical Connections .....	9
4.5.1 Power .....	9
4.5.2 Outputs – Voltage & Current .....	9
4.5.3 Alarm Contacts.....	10
<b>5.0 Operation</b> .....	11
5.1 The Sensor/Sampler .....	11
5.2 The Analyzer .....	11
5.3 The Graphing Screen.....	12
5.4 Menus .....	13
<b>6.0 Calibration</b> .....	14
6.1 Calibration Procedures .....	14
6.2 EEPROM Programming Correction .....	14
<b>7.0 Automatic Control</b> .....	15
7.1 Optimization of Treatment Process .....	15
7.2 PI Control Overview .....	15
7.3 PI Control Procedure .....	16
7.3.1 Process Band Calculation.....	16
7.3.2 Entering the Control Parameters .....	17
7.3.3 Manual Control .....	17

## Table of Contents (continued)

Section	Page
<b>8.0 Additional Features and Options</b> .....	18
8.1 Sensor Gain Switch .....	18
8.2 Remote Panel Meter .....	18
8.3 Optional Flow Switch.....	18
<b>9.0 Routine Maintenance</b> .....	19
9.1 Preferred Method – Chemical Cleaning.....	19
9.2 Manual Cleaning .....	19
9.3 Analyzer Fuse .....	20
<b>10.0 Troubleshooting</b> .....	21
10.1 Diagnostic Chart .....	21
10.2 Technical & Customer Assistance .....	21
<b>11.0 Accessories and Replacement Parts List</b> .....	22
<b>12.0 Definitions</b> .....	23
<b>13.0 Warranty</b> .....	24

## Specifications

<b>Measurement Range</b>	± 10.0 SCU or ICu
<b>Accuracy</b>	± 1 % of Full Scale
<b>Repeatability</b>	1%
<b>Linearity</b>	± 1%
<b>Resolution</b>	0.01 SCU or ICu
<b>Response Time</b>	1 second
<b>Analyzer Display</b>	Backlit Graphical LCD with trending
<b>Alarms</b>	Two Programmable, One Sensor, 120-240VAC 2A Form C Relay
<b>Analog Output</b>	Powered 4-20 mA, 1000 Ω drive
<b>Communications Port</b>	Optional RS-232 or RS-485
<b>Flow Rate</b>	6.0 – 9.5.0 L/min. (1.5 -2.5 gpm)
<b>Flow Alarm</b>	Optional Float Switch
<b>Operating Temperature</b>	0°C – 50°C (32°F – 122°F)
<b>Storage Temperature</b>	-20°C – 60°C (-4°F – 140°F)
<b>Wetted Materials</b>	HDPE, PTFE, Stainless Steel, Neoprene, ABS
<b>Standard Cable Length</b>	7.62m (25 feet)
<b>Max. Sensor to Analyzer</b>	76.25 m (250 feet) Consult factory for lengths over 50 feet
<b>Power Source</b>	120 or 240 VAC, 50/ 60 Hz, 40VA
<b>SCM Sensor Case</b>	Designed to meet IP 66 /NEMA 4X
<b>Analyzer Regulatory Compliance And Certifications</b>	CE Approved, ETL listed to UL 3111-1 & ETL Certified to CSA 22.2 No. 1010-1-92
<b>Shipping Weight</b>	6.8 kg (15lbs.)
<b>Shipping Dimensions</b>	62 cm X 44 cm X 35cm (24 ¼“ X 17 ¼“ X 14”)
<b>Warranty</b>	1 Year from date of shipment

## 1.0 Overview

The SCM–Streaming Current Monitor allows for optimizing and control of dosing coagulants used for clarification of water. Although the analyzer is capable of displaying the units in either SCU’s or ICu, this manual will always refer to SCU.

### 1.1 Unpacking and Inspection of the Instrument and Accessories

The table below indicates the items in the shipment.

Item	Quantity
MicroTSCM Analyzer	1
SCM Sensor	1
Sample Chamber	1
Calibration Kit	1
Instruction Manual	1

Remove the instrument from the packing carton. Carefully inspect all items to ensure that no visible damage has occurred during shipment. If the items received do not match the order, please immediately contact the local distributor or the HF scientific, inc. Customer Service Department.

## 2.0 Safety

This manual contains basic instructions that must be followed during the commissioning, operation, care and maintenance of the instrument. The safety protection provided by this equipment may be impaired if it is commissioned and/or used in a manner not described in this manual. Consequently, all responsible personnel must read this manual prior to working with this instrument.

In certain instances “**Notes**”, or helpful hints, have been highlighted to give further clarification to the instructions. Refer to the *Table of Contents* to easily find specific topics and to learn about unfamiliar terms.

### 2.1 Symbols Used In the MicroTSCM

Standard IEC symbols are used on the high voltage cover.



ISO 3864, No. B.3.6 Caution, risk of electric shock.

This symbol indicates that hazardous voltages may be present under this cover



ISO 3864, No.B3.1 Caution refers to accompanying documents.

This symbol is a reminder to read the sections in the manual referring to the electrical connections, and potential hazards.

### 3.0 Theory of Operation

In a liquid form, water molecules move around each other at a fast rate. One affect of this fast movement is the ability to suspend matter. This phenomenon is called “Brownian Motion”. It occurs when microscopic particles are maintained dispersed in suspension due to their random bombardment by the fast movement of water molecules. Typical particles found in raw water entering WTP have finely divided clay particles and organic matter collectively called silt.

A second phenomenon which stabilizes the suspension is the surface charge of the suspended matter. When a salt such as sodium chloride is place in water, complete dissolution occurs. This system reaches a stable energy level when the individual sodium and chloride ions ( $\text{Na}^+$  and  $\text{Cl}^-$ ) are separated in the water phase by being surrounded by water molecules.

In the case of large pseudo salts, e.g. Aluminosilicates (clay), only partial dissolution takes place due to incomplete breakdown of the crystal to individual ions. The structure of these clays is similar to silica or sand except that random silicon atoms in the crystal are replaced by aluminum atoms in the cage structure, causing the clay to swell and crack between adjacent aluminum atoms in the crystal. Thus a clay particle is formed with a size of less than 1 micron with a negative charge. This particle is small enough to be maintained in suspension by Brownian Motion. The particles in the suspension repel each other due to their surface charge, preventing them from coming together and agglomerating, or flocking to form a larger particle, which would settle out. The result is an energetically stable system and is the reason why the particles remain dispersed.

The counter ions (say sodium for the sake of argument) are separated from the large cage structure because they are dissolved in the water. Clay particles have a negative charge associated with it, while the counter ions, typically cat-ions (or positively charged ions) are dispersed in the water phase.

In the case of most naturally occurring substances, the larger ion, when in suspension, has a negative net charge (anionic). The smaller, counter ion is positive (cationic). The residual charge of the larger particles is negative, which causes them to repel each other, preventing them from forming agglomerates. The size of the particles never becomes large enough to settle out, so they remain dispersed in suspension.

This phenomenon creates an energetically stable system. In order to cause the suspended particles to agglomerate and settle out, the energy of the system must be upset. There are numerous mechanical means to accomplish this, but the addition of chemical flocking agents to the suspension, drastically reduces the time and is far more efficient.

Chemical additives perform two functions, charge neutralization & bridging. Both of these techniques allow the small particles to floc and grow sufficiently that Brownian motion can no longer support them. Due to the high density of the particle, flocs will form and settle as fine sludge.

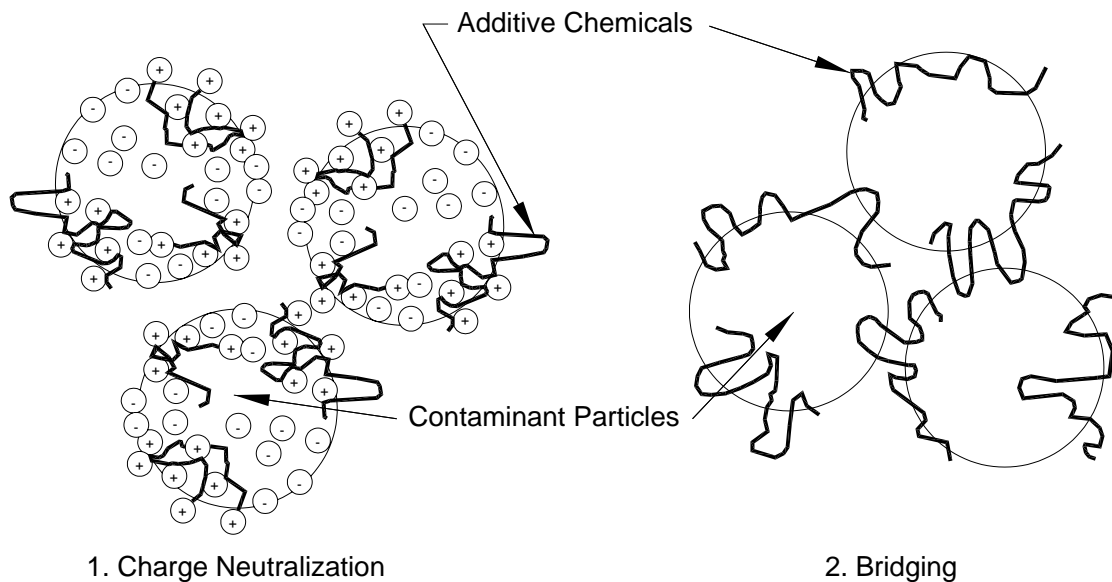

**Figure 1: Effects of Chemicals**

### 3.1 Treatment of Water for Clarification

Most water treatment chemicals consist of a cationic (positively charged) chemical e.g. aluminum salts, ferric salts, polyamines or cationic polyacrylamides, some of which have the cationic part tagged on to a long polymer chain. As stated earlier, raw water entering the WTP is an energetically stable system of suspended particles with a net negative charge. Cationic chemicals are added to bring the charge to neutral.

Before the development of Streaming Current technology, the best way to determine the optimum dosage has been the jar test method. The jar test involves taking a representative sample of the water being treated and placing it in several jars. Different amounts of clarifying chemicals are added to each jar; stirred and comparing the clarity of the water in the different jars. Jar tests are time consuming and it is difficult to reproduce the conditions of the WTP in a jar. The tests can take several hours rendering them useless when plant personnel are really responding to rapid changes in water quality. A typical curve of Turbidity vs. Chemical dosage is shown in Figure 3.

Some considerations when treating the water are the rate of floc formation, the size of the floc formed, how fast the floc settles, and the clarity of the final settled and filtered water.

Other techniques exist, such as a dosing curve, which indicates a recommended dosage for a given water turbidity. This is generally built up over years of dosing experience with the water, but has the disadvantage that turbidity caused by extremely small particles requires a higher dosage than that caused by larger particles, and therefore can only be adapted for use with known type turbidity on any given water.

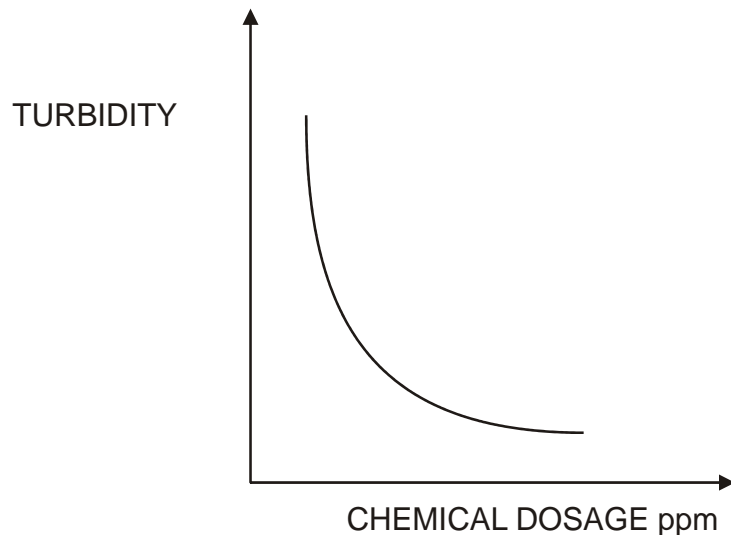

**Figure 3: Turbidity vs Dosage**

### 3.2 Charge Analysis

Charge analysis is the measurement of the electro kinetic charge of a solution due to the presence of charged particles. The electro kinetic charge can be measured by a number of different methods.

#### 1. Applied electric field

Measurement: The relative mobility of the solid or liquid phase.

This is the first method developed for calculating the Zeta Potential. The motion of charged particles under the influence of an electric field was observed and the potential required to achieve a certain amount of particle mobility was measured.

A cell consisting of two flat plates separated by approximately 0.1 mm and having an electrode at each end of the cell is filled with water containing suspended matter. When an electrical potential is applied to the electrodes, the particles can be observed to drift toward one of the electrodes. The Zeta Potential is calculated from the measured speed of particle drift.

#### 2. Induced Electrical Potential

Measurement: The potential developed as the result of forced movement of particles in the solution.

This is the method used by the MicroTSCM. Continuous sample water is directed into an annulus, inside which a displacement piston oscillates vertically at a fixed frequency. This action causes the liquid to move between the two stainless steel electrodes. The suspended particles are absorbed onto the walls under the action of Van der Waal's and electrostatic forces. As the sample is moved rapidly back and forth, mobile counter ions surrounding the colloids are sheared near the surface of the walls and moved past the electrodes. The resultant A.C. signal or Streaming Current, proportional to charge density, is electronically processed and displayed.

## 4.0 Installation and Commissioning

### 4.1 Sample Point

Careful consideration must be given to where in the system the sample will be taken. Streaming current monitoring requires sampling of the raw water after the introduction of coagulant. It is critical that the sample point is far enough from the dosage point to ensure good mixing. The sample point should be at least 10 pipe diameters away from the dosing point to ensure ample mixing.

Equally important is the lag time from when a change in dosage occurs to when it shows up at the sensor. If the sample point is too far from the dosing point, it will take too long for changes to reach the sensor and control of the loop will not be possible. A lag time not greater than 10 minutes is recommended.

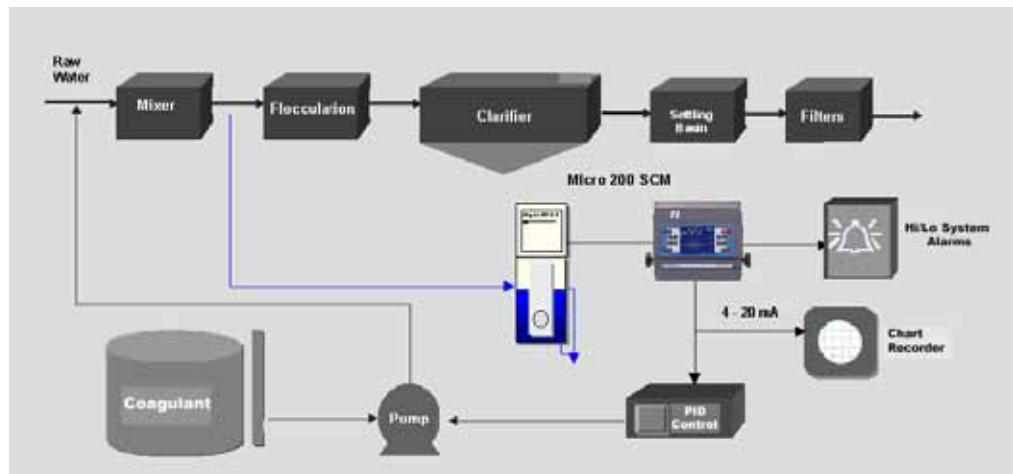

Figure 3: Typical Installation

### 4.2 Flow Rate

The absolute minimum flow required is 6 liters per minute (1.5 gpm). The sample is designed to handle flow rates of up to 10 liters per minute (2.5 gpm). Run the flow as close to the maximum as possible without overflowing the sample chamber.

**Note:** The sample flow must be free of large shells or other debris that might clog the orifices or cause damage to the sensor. Supplying an adequate flow free of debris is the responsibility of the installer.

*Suggestion: If meeting the minimum flow rate may be a problem, the optional flow alarm may be required. HF Catalog #19886. See section 8.3. To prevent large debris from entering the sample chamber, a 40 mesh screen strainer is recommended.*

### 4.3 Sensor Mounting & Plumbing

Locate the sensor as close to the sampling point as possible to reduce lag time. A site that is protected from the elements (sun, rain etc.) is preferred, but the sensor is rated for use under most outdoor conditions. The sample chamber is designed to be mounted with 1/4" diameter bolts. The sensor does not get firmly mounted, but just sits on top of the sample pot. A light shield protects the clear sample pot cover & helps to prevent algae growth. Refer to the diagram below for mounting dimensions.

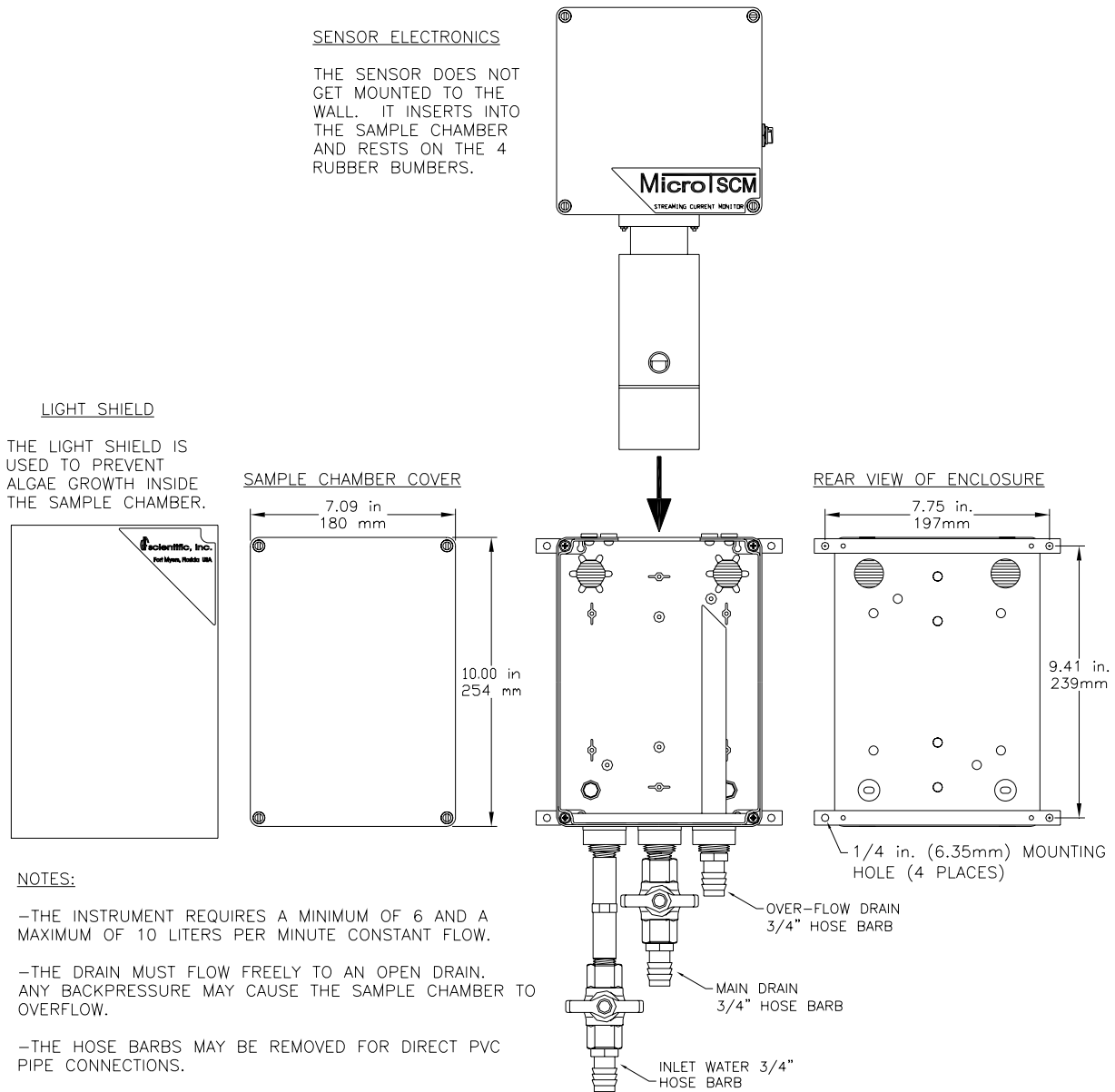

**Figure 4: Sensor/Sample Chamber Mounting**

#### 4.4 Analyzer Mounting

The analyzer is not weather tight and this must be taken into consideration during site selection. The analyzer provides the control outputs via 4-20 mA and alarms. It is recommended that the analyzers be mounted in a location for easy viewing and keypad access. The analyzer can be flipped on its mount to gain access to the electrical connections.

Please refer to the drawing below for mounting dimensions and hole location.

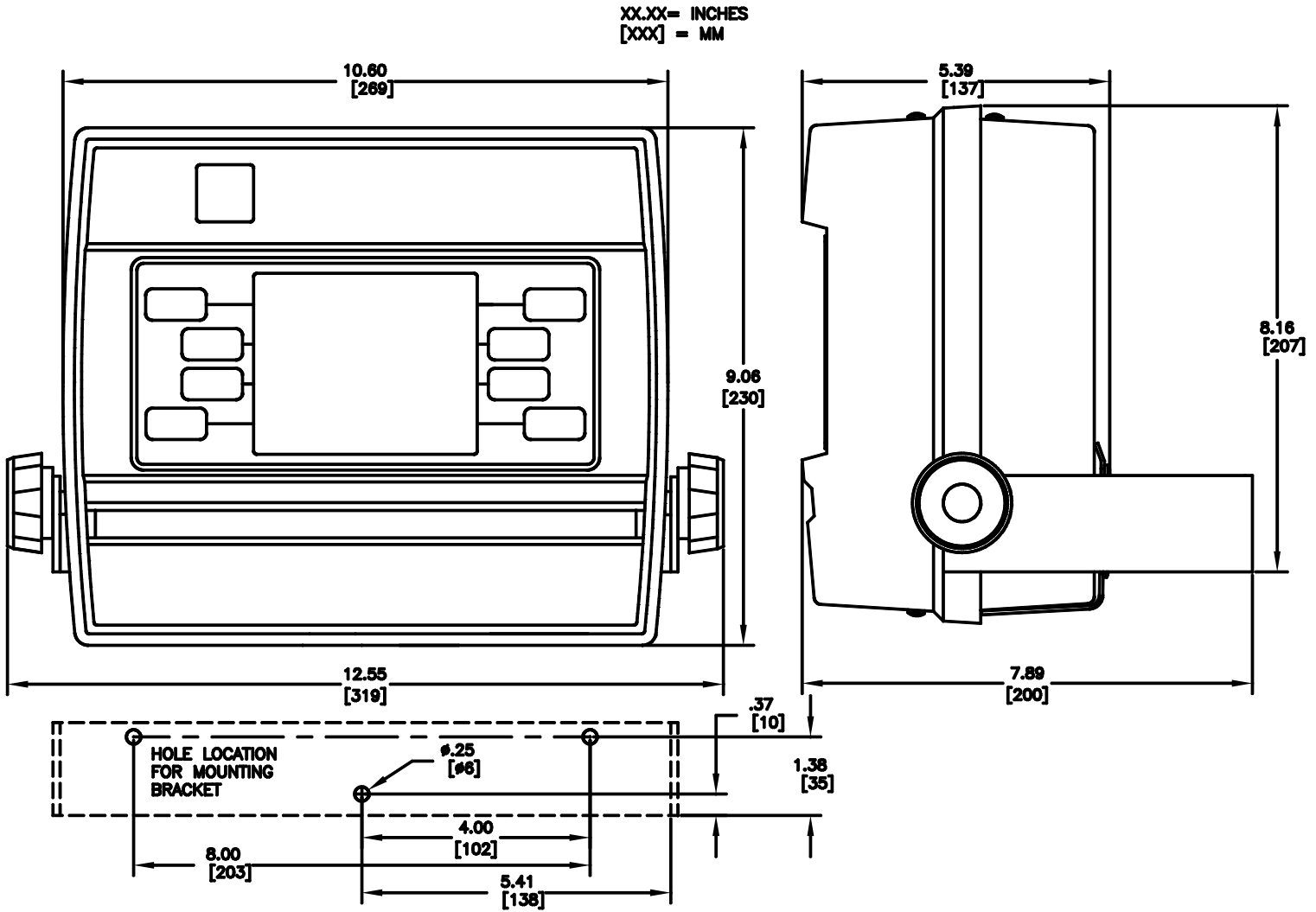

Figure 5: Analyzer Mounting

## 4.5 Electrical Connections

All of the electrical connections to the instrument are made at the termination area which is located in the back of the analyzer under the access cover. Refer to Figure 6 carefully as the wire colors do not follow the actual PCB screen printing. For easy access, loosen the two clamping knobs and rotate the instrument upside down. Remove the access cover.

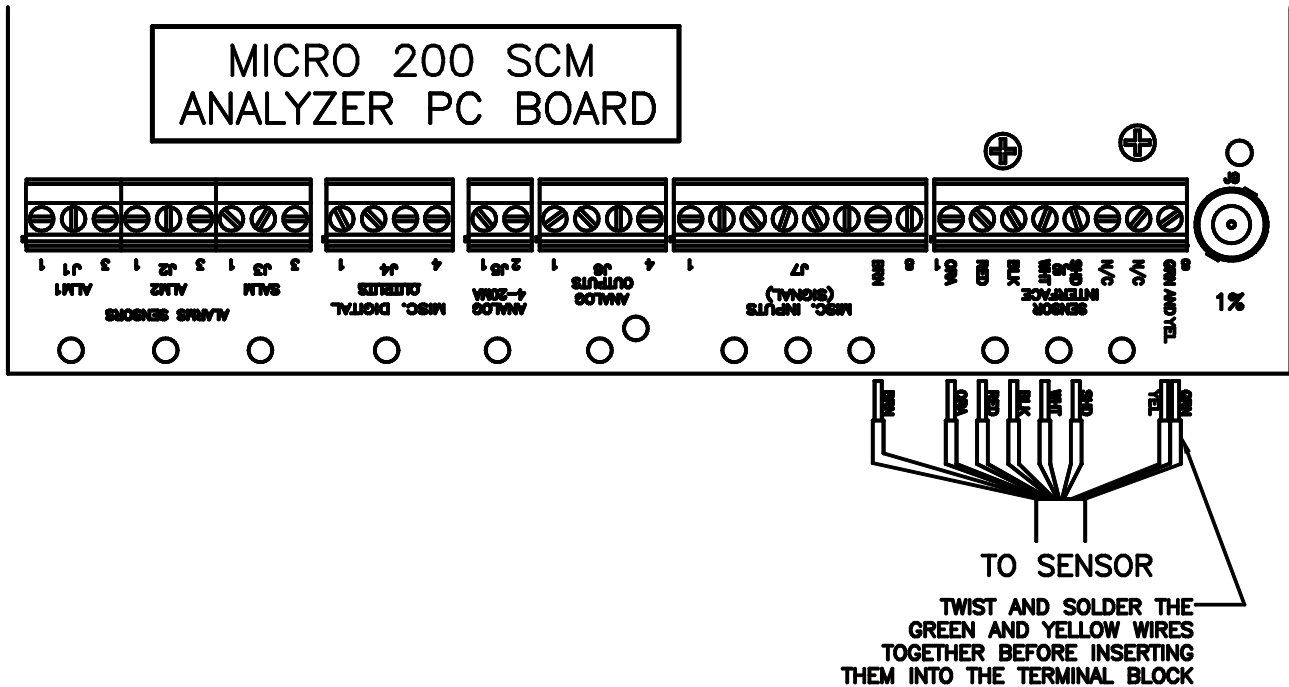

Figure 6: Analyzer Electrical Connections

### 4.5.1 Power



**Note:** Only qualified electricians should be allowed to perform the installation of the instrument as it involves a line voltage that could endanger life.

The power requirements for the analyzer are 40VA at 120 or 240 VAC. The voltage is set at the factory based on the shipping destination; however the setting should be checked prior to power connection.

To change the voltage, the fuse cartridge must be removed and rotated. The voltage is indicated by the two arrows that point toward each other. A flat bladed screwdriver inserted into the slot provided may be used to remove the fuse cartridge. See the Figure 11 in section 9.3.

### 4.5.2 Outputs -Voltage & Current

The analyzer can be set to output either voltage or 4-20 mA. This selection is made in the DISPLAY PARAMETERS menu of the analyzer.

Use twisted pair shielded cable 22AWG-14 AWG for the voltage or current outputs. Tie the shield at the recorder end only. Do not connect the shield at the analyzer.

The voltage connections are made at J6 as shown below:

<b>Terminal J6</b>	<b>Connection Purpose</b>	<b>Impedance</b>
Terminal 1	0-10V	50K ohm or greater
Terminal 2	0-1V	5K ohm or greater
Terminal 3	0-100 mV	500 ohms or greater
Terminal 4	Common	N/A

The 4-20 mA connection is made at J5. Terminal 1 is positive, Terminal 2 is negative. The recorder load may be up to 1000 ohms.

Galvanic isolation may be achieved by removing the jumper at J13. This procedure will require the removal of the entire rear cover assembly.

#### **4.5.3 Alarm Contacts**

Connections can be made to the two user settable alarms and the sensor alarm at the terminal block labeled ALARMS.

Note: these alarms are fail safe and will revert to an alarm condition in the event of no power being applied to the analyzer.

The maximum alarm contact ratings are 250VAC @ 5.0A. Ensure that loads do not exceed these ratings.

As indicated on the PCB, the following are terminal blocks:

J1 – Alarm 1

J2 – Alarm 2

J3 – Alarm 3

In all cases the following connections apply:

Terminal 1: Normally Closed (N.C)

Terminal 2: Normally Open (N.O.)

Terminal 3: Common (C)

Do not use wire larger than #14 AWG as the terminal blocks will not accept it.

## 5.0 Operation

The SCM system consists of three major components, The Sensor, the Sample Chamber and the Analyzer.

### 5.1 The Sensor/Sample Chamber

The sensor module sits on top of the sample chamber, with the probe end below the water level. The sample chamber has three valves to adjust the flow:

- The inlet should be adjusted such that there is always a sample present. A lack of a sample will cause premature wear in the cell and piston.
- The main drain needs to be adjusted open as much as possible to allow the larger particulates to drain while the sample water is measured.
- The overflow valve is usually connected to the main drain and is left fully open. Its purpose is to keep the sample chamber from overflowing.

To prevent back flow and allow proper draining it is important that both drains are left open to the atmosphere and kept at short as possible.

If heavy particulates can be present in the water it is important to install a 40 mesh strainer before the inlet. The flow should also be kept low to allow large sand and larger debris to fall to the bottom of the sample chamber and drain, without causing harm to the sensor.

The sample chamber has a cover to reduce algae growth. This cover may be easily removed for service.

### 5.2 The Analyzer

Detail is not provided on individual menus as most are self explanatory. Notes are used, where needed to bring attention to important information.

There are a few analyzer keys which have special purposes as described below.



This key resets the alarms after an alarm condition has been met. A screen display of the alarm will continue until the alarm condition is relieved. Alarms will also reset themselves without intervention if instrument reading returns to a non- the alarm condition.



The Enter/Menu key is used to either invoke the Main Menu while in the graphing screen or to return to the previous menu.



These two buttons are used to modify values or to scroll through possible selections.

### 5.3 The Graphing Screen

Shown below in Figure 7 is the main graphing screen. The numbers are used to identify various features.

1. The larger number area shows the current reading and units used.
2. The graph time base. Options are 8 or 24 hours and can be set in the Display Parameters Menu.
- 3 & 4. The upper and lower display limits. These are settable in the Display Parameters Menu. Please note that these settings also affect the 4-20 mA /Voltage range.
- 5 & 6. Alarms 1&2. These can be set in the Alarms Setup Menu. These will flash on the graphing screen if in an alarm condition.
- 7 & 8. Current time & date. This can be set in the Monitor Setup Menu.
9. Streaming current graph.

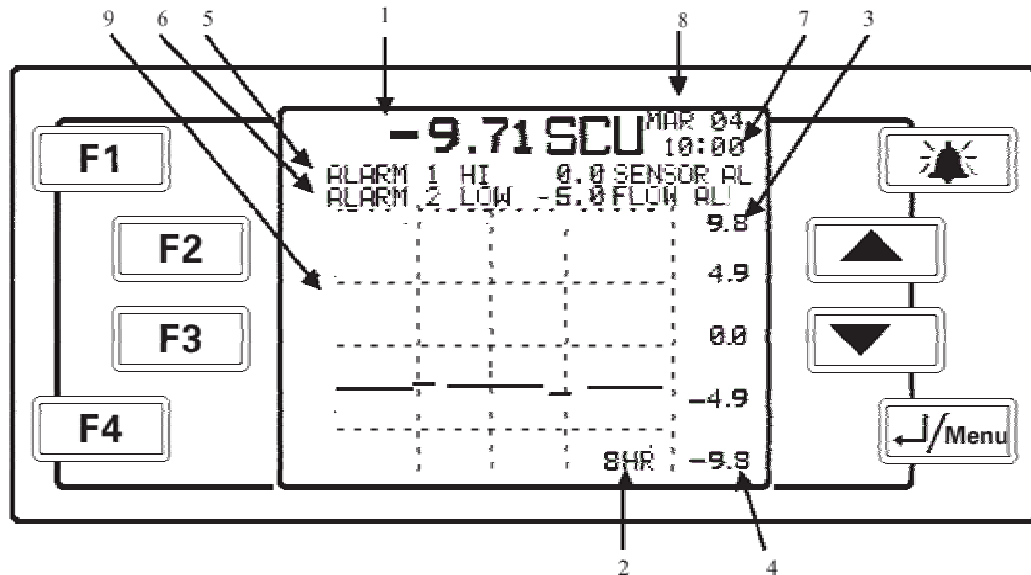

Figure 7: Analyzer Screen

## 5.4 Menus

The following flow chart can be referred to for the menu structure.

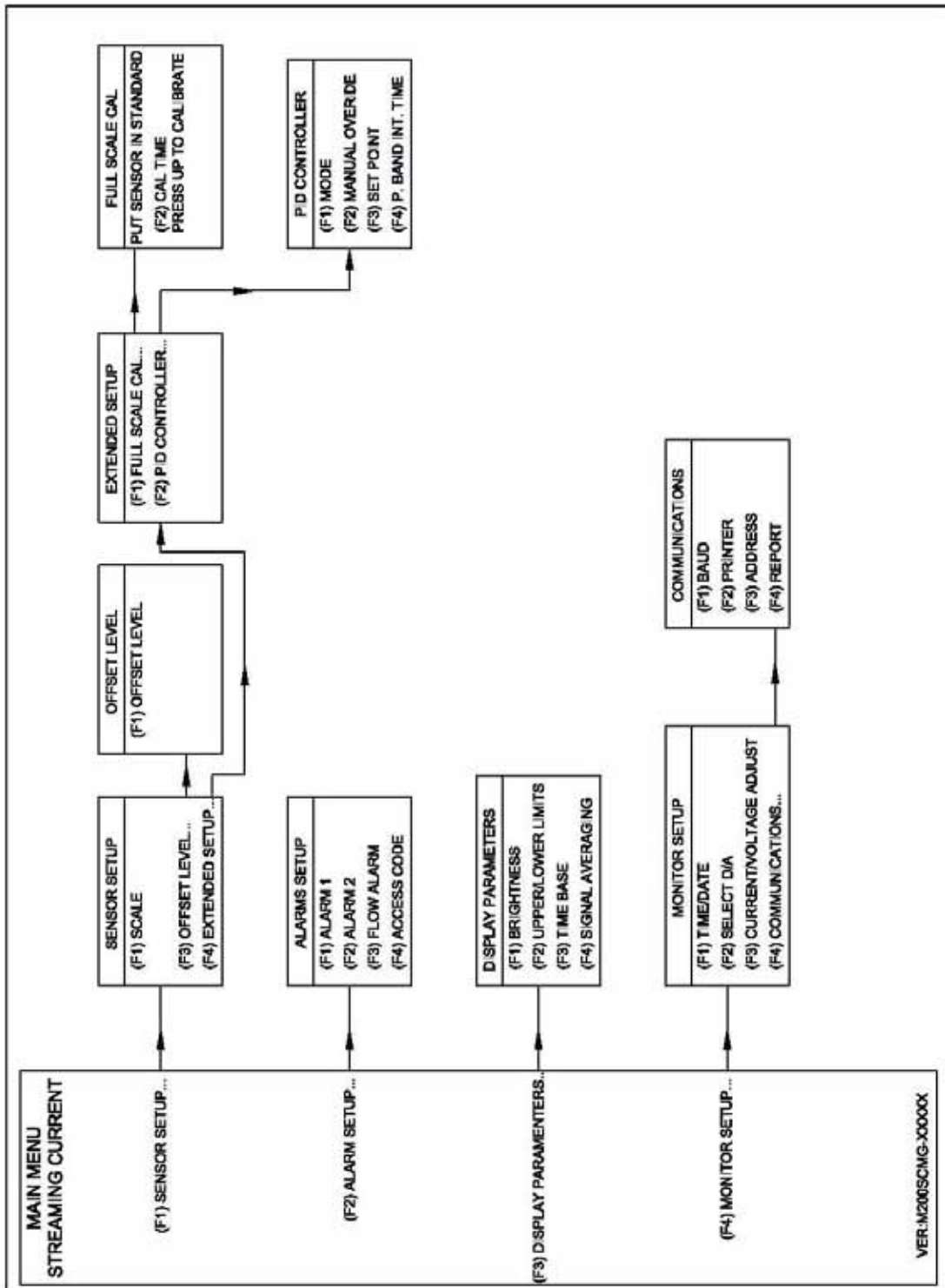

Figure 8: Menu Flow Chart

## 6.0 Calibration

The MicroTSCM has been calibrated at the factory, however to ensure accuracy it is recommended that the instrument be calibrated prior to being placed online. Long term drift may occur in this instrument and HF scientific inc. recommends calibration every three months.

To facilitate the initial calibration, a calibration kit, Part # 19922 is supplied with this instrument. When prepared according to the included instructions a +5.30 SCU Cationic calibration solution is produced. Allow this solution to stand for one hour prior to use.

In preparation for calibration ensure that previously operated sensors are rinsed with, and then operated in, clean water, for several minutes.

### 6.1 Calibration Procedures

Place the sensor in the Cationic Standard and allow it to stand for about 15 minutes. Ensure that the gain switch is set to OFF. See [section 8.1](#)

On the Analyzer ensure that the Offset Level is set to 0.00 and the signal averaging is turned OFF. To calibrate, on the Analyzer, go to Sensor Setup → Extended Setup → Full Scale Cal. → Cal Time. The ▲ key will initiate the calibration, which will take 60 seconds.

At the completion of the calibration, ensure that the reading is +5.10 to +5.50 SCU. If the reading appears unstable initiate another calibration. If the +5.30 SCU calibration value is not achievable, refer to [section 6.2](#).

Rinse the sensor with clean water prior to returning to service.

As a check, an Anionic solution can be made using a 100mg/l dishwasher detergent solution. An acceptable reading would be -4.0 to -6.0 SCU.

**Note: Do not attempt to calibrate on an Anionic solution.**

### 6.2 EEPROM Programming Correction

If the calibration in the Cationic solution does not achieve a reading of +5.10 to +5.50 SCU, the EEPROM has probably lost the storage value and will need to be reprogrammed.

This will need to be performed at the sensor while operating in the calibration solution. Remove the sensor cover by loosening the four corner captive fasteners. Inside locate a small DIP switch with four white sliders labeled SW4. Above this switch are two push buttons labeled SW2 and SW3. On the DIP switch flip the slider labeled 3 up. The analyzer should display +5.30. If it does not adjust the value with the push buttons; SW2 will increase the value (UP) SW3 will decrease the value (DOWN). Adjust until the Analyzer reads exactly +5.30 SCU. Flip the slider on the DIP switch down to store the adjustment.

Attempt another calibration from the Analyzer as in [section 6.1](#). If the correct calibration values are still not achievable, call HF scientific inc. Technical Service Department for assistance.

## 7.0 Automatic Control

This section describes the use of the SCM to control the process. It is recommended that a review of [section 4.1](#) (sample point) is made to ensure correct installation.

### 7.1 Optimization of Treatment Process

Prior to turning control over to the SCM, it is crucial to optimize coagulant dosing. The optimum point is obtained when the minimum coagulant can be fed that produces the desired results for any particular treatment process. This should be done slowly and in steps.

**Step 1:** Track the water quality parameters over the course of several days to establish a base line of data from which to measure acceptable water quality.

*Suggestion: The Installation Evaluation format the back of this manual is a tool that can be used to track water quality parameters.*

**Step 2:** After the base line of acceptable water quality has been reached, reduce the coagulant dosage by 5% and closely monitor the water quality.

**Step 3:** Continue reducing the dosage in 5% increments until there is a detectable reduction in water quality. Increase the dosage from this point by 5% and continue monitoring for another hour.

**Step 4:** Record the SCU value on the instrument as this will be the optimized set point (SP) for operating the plant.

**Note:** There may be a different set point for extreme variations in raw water quality or demand on the system e.g. winter versus summer.

### 7.2 PI Control Overview

The MicroTSCM can be incorporated into an existing control scheme using the 4-20mA or serial outputs. Plant control can also be achieved using the optional Proportional Integral feature included in the MicroTSCM analyzer (HF Catalog # 19550 only).

When the instrument is used to automatically control coagulant dosing, it monitors the process value (PV) for a change in charge value and then adjusts the dosage up or down to achieve the predetermined set point (SP). Using a control algorithm or process calculation, the analyzer determines the pump speed that is required to keep the PV and SP values the same, which is the function of any closed loop control system.

When placed under automatic control, the instrument performs the same tasks that an operator would be required to make. An operator adjusts the dosage level, allows time to account for mixing and then checks the process for the desired change. Additional changes to the dosage level are made as required. Under automatic control, the instrument constantly monitors the process value and makes adjustments as needed to maintain the process reading at the set point.

In order to put the plant under automatic control, it is required to provide some basic information to the analyzer that describes how the system responds to changes. The variables that need to be determined are the Proportional Band and the Integral Time. The Proportional Band tells the instrument what change in Streaming Current to expect for a

given change in coagulant dosing. The Integral Time tells the instrument how long it will take to fully realize the effects of a change in coagulant dosing.

### 7.3 PI Control Procedure

The assumption is that the wiring between the MicroTSCM analyzer and the dosing pump has been installed. The following procedure is recommended to determine the correct Proportional - Integral (PI) values for any particular system. The MicroTSCM analyzer is used to slow down the control loop to prevent overdosing of coagulant. A calculation based on test data determines the Proportional Band or P. Band and is the final value that will be entered into the analyzer. A hypothetical example of the procedure will be used to demonstrate the calculation of these values. These values will need to be determined for any particular system and can be plugged into the following equations to determine the appropriate analyzer settings.

Steps:

1. Ensure the plant is operating at a steady SCU reading with a fairly constant flow rate. Record this SCU value.
2. Adjust the dosing pump to give a 10% increasing dosing output.
3. Start timing when the change was made (a stopwatch is helpful).
4. Monitor the MicroTSCM and stop timing when the SCU value has changed and leveled off.
5. Record this time period in seconds. This is the Integral Time setting.
6. Record the new SCU value when the change has fully leveled off.

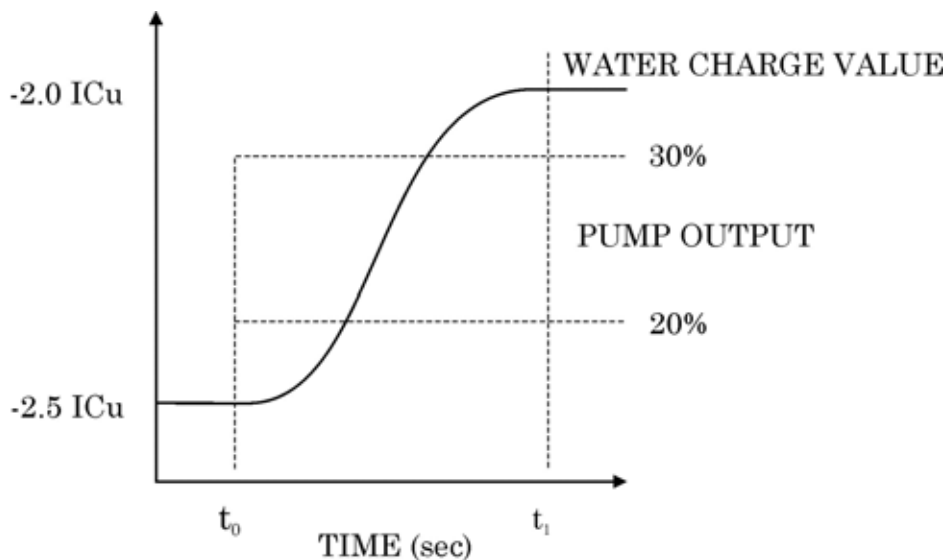

Figure 9: Effect of Dosing Change

#### 7.3.1 Proportional Band Calculation

For our hypothetical *example*, the cause of change was the 10% increase in pump output i.e. 10% more coagulant was dosed into the water. Due to the requirement to mix the coagulant with the carrier water and move it through the volume of the sample pot, we observed a time lag. The total time from when the change was made to when the full effect was noticed was 100 seconds. This will be entered later as the Integral Time (INT).

TIME). The SCU reading changed was from -2.5 SCU to -2.0 SCU; a change of 0.5 SCU. Convert the effected change in SCU to a percentage. Since the instrument always operates in a range of +10 SCU to -10 SCU, the range is 20 SCU.

$$\% \text{ effect} = \frac{\text{Effect}}{\text{Range}} \times \frac{100}{1}$$

Then calculate the proportion band or PB.

$$\text{PB} = \frac{\% \text{ Effect}}{\% \text{ Cause}} \times \frac{100}{1}$$

In our *example* calculating the Proportional Band or P. Band with a 10% change (cause):

$$\% \text{ effect} = \frac{0.5 \text{ SCU}}{20.0 \text{ SCU}} \times \frac{100}{1} = 2.5\%$$

$$\text{PB} = \frac{2.5\%}{10\%} \times \frac{100}{1} = 25\%$$

To prevent overshoot, it is desirable to slow the control loop down a little more. To do this the PB is multiplied by 1.5.

In our *example*:

$$\text{PB} = 25\% \times 1.5 \approx 38\%$$

Once the control parameters are set into the analyzer and the dosing pump has been set, the SP may need to be adjusted to account for seasonal change, but other than routine maintenance and monitoring, no other adjustments should be required.

### 7.3.2 Entering the Control Parameters

The next step is to enter the control parameters into the MicroTSCM analyzer. To do this, follow the steps:

1. Press **←/Menu** to enter the Main Menu screen.
2. Press **F1 (Sensor Setup)** to enter the Sensor Setup screen.
3. Press **F4 (Extended Setup)** to enter the Extended Setup screen.
4. Press **F2 (PID Analyzer)** to enter the PID Analyzer screen.
5. At **F1 (Mode)** toggle the highlighted setting to AUTO using the **▲▼** buttons.
6. Press **F3 (Set Point)** adjust the Set Point (from [section 7.1](#)) using the **▲▼** buttons.
7. Press **F4 (P. BAND)** adjust value using the **▲▼** buttons (in our example 38.00).
8. Press **F4** again (**INT. TIME**) adjust value using the **▲▼** buttons (in our example 100).
9. Press **←/Menu** four times to return to the graphic monitoring screen.

### 7.3.3 Manual Control

To operate the system in manual mode, follow the steps 1-4 above, on step 5 use the **▲▼** buttons to adjust the setting to MANUAL. Select F2 and a new setting called MANUAL OVERRIDE will show. Adjust the value using the **▲▼** buttons. A +10 will increase the pump speed by 10% and -10 will decrease pump speed by 10%. Please note that the speed change may not be representative of dosing rate.

## **8.0 Additional Features and Options**

### **8.1 Sensor Gain Switch**

The gain toggle switch is mounted on the side of the sensor housing. The purpose of the gain switch is to increase the magnitude of the sensor's response. The gain switch can be used in applications where little response is noted to changes in coagulant dosing. When deciding to use the gain switch try the LOW setting first. If the response is not adequate, use the HIGH setting. Always be sure this switch is turned to OFF (center position) when calibrating.

As increasing the gain may over-range the reading, this feature should not be used unless the reading is near zero.

### **8.2 Remote Panel Meter (Catalog # 19609)**

The optional remote panel meter allows for remote indication of the SCU reading using the 4-20 mA loop of the MicroTSCM. No external power is required, as the meter is powered from the 4-20 mA source of the MicroTSCM analyzer.

### **8.3 Optional Flow Switch (Catalog # 19886L)**

The flow switch is actually a float level switch. This is a factory installed option that will alert an operator to a lack of flow. Once actuated a low flow condition will be indicated on the screen as well as sending the 4-20 mA signal to ground and closing the alarm contacts. There is a user setting in the analyzer to determine how long a lack of flow is required to initiate an alarm.

## 9.0 Routine Maintenance

The most important maintenance procedure is to keep the sensor clean. The need for cleaning is indicated when normal readings cannot be maintained. As a preventative measure, cleaning intervals of 30 days or less is recommended. There are two recommended cleaning methods.

### 9.1 Preferred Method – Chemical Cleaning

Pour the SCM-1 cleaning solution (Catalog # 19402) into a suitable container, large enough to immerse the lower 1/2 of the probe body. Run the sensor in this solution for approximately 10 minutes. Then run the instrument for about 10 minutes in clean water.

For organic debris, replace the cleaning solution with a 5% chlorine solution.

Please refer to the Material Safety Data Sheet for proper handling of the SCM-1 cleaning solution.

### 9.2 Manual Cleaning

In extreme conditions, the cell will have to be removed and cleaned with an abrasive cleaning pad such as Scotch-Brite® and a small brush.

Always rinse the probe out with clean water prior to starting.

1. To expose the cell and probe area, remove the bottom cap by turning it CCW (as viewed from the bottom). Be careful to retain o-rings and seals.
2. Carefully pull the Cell out of the probe end, about 25-50 mm (1-2 inches)
3. Clean the inside of the cell with a stiff toothbrush and an abrasive pad such as (Scotch-Brite®). The aim is to remove all debris and polish all stainless steel surfaces.
4. Rinse the cell with water.
5. Loosen the shaft-retaining nut with a 10mm wrench and from the bottom of the sensor unscrew the probe.
6. Completely remove the nut then pull the probe out.
7. Polish the probe with the abrasive pad.
8. Reinstall the probe, adjusting the probe such that it misses the bottom of the cell by 1-2 mm, then snug the 10mm retaining nut. DO NOT OVER-TIGHTEN.
9. Completely dry off any water that is in and around the cell cap, the bottom of the cell and the O-rings and seals.
10. Reassemble the lower seals and install the cap very firmly by hand.
11. Rotate the motor slowly by hand to ensure the probe does not hit the cell bottom. If there appears to be any contact adjust the probe up slightly.
12. If the probe does not rotate freely inside the cell, check for obstructions. This condition will cause premature motor wear.

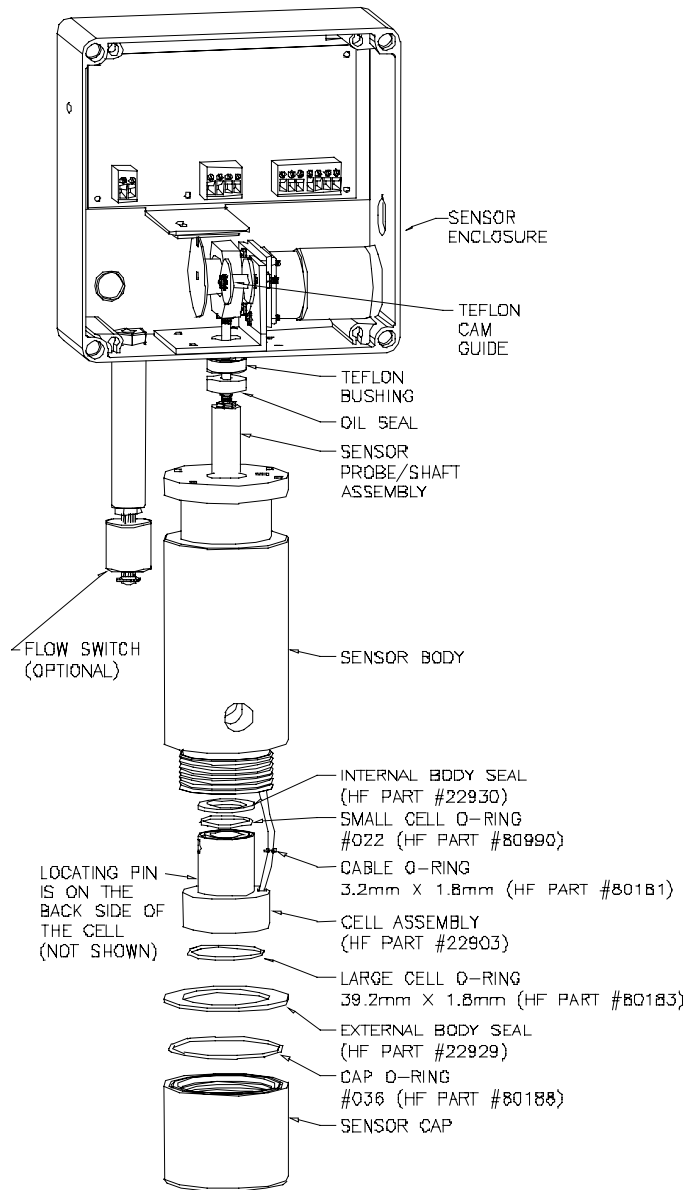

**Figure 10: Sensor – Exploded View**

### 9.3 Analyzer Fuse

The analyzer fuse located in a cartridge on the cord receptacle in the back of the instrument. To gain access, remove the four access cover screws and remove the power cord. Insert a screwdriver into the slot and pry to remove the cartridge. Be certain to match the desired voltage with the indication arrow when reinserting the cartridge.

**Indication of Voltage Setting**



**Insert a flat blade screwdriver to remove fuse cartridge  
Figure 11: Fuse**

## 10.0 Troubleshooting

### 10.1 Diagnostic Chart

Symptom	Solutions
Analyzer Display Not Lit.	<ol style="list-style-type: none"><li>1. Make sure the unit is plugged in and turned on.</li><li>2. Make certain that the power source is providing the correct voltage.</li><li>3. Make sure the analyzer is set for the correct voltage.</li><li>4. Check analyzer fuse.</li></ol>
Sensor probe not moving	<ol style="list-style-type: none"><li>1. Check the interconnect cable connection at the sensor.</li><li>2. Check the wiring of the interconnect cable on the back of the analyzer and inside the sensor.</li><li>3. Check to ensure the probe is not jammed.</li></ol>
Display Response is Slow	<ol style="list-style-type: none"><li>1. Select a lower Signal Averaging period.</li><li>2. Separation between dosing and sample points too great.</li></ol>
Readings Different than expected	<ol style="list-style-type: none"><li>1. Sensor requires cleaning.</li><li>2. Sensor requires calibration.</li><li>3. Check Probe and Cell for wear. Replace parts as required.</li></ol>
Unable to Achieve 5.3 SCU after Calibration	<ol style="list-style-type: none"><li>1. Manually reprogram calibration as described in section <b>6.2 EEPROM Programming Correction</b>.</li></ol>
Sensor Alarm Indication on Analyzer	<ol style="list-style-type: none"><li>1. Check that sensor is operating correctly.</li><li>2. Check wiring connections at both the analyzer and the sensor.</li></ol>
Reading Fluctuate, Unstable	<ol style="list-style-type: none"><li>1. Incomplete mixing of coagulant with sample water.</li><li>2. Sensor and or sample chamber require cleaning.</li><li>3. Check coagulate dosing operation.</li></ol>
Reading Doesn't Change with a Change in Dosing	<ol style="list-style-type: none"><li>1. Sensor may require cleaning.</li><li>2. Check sample flow to sample chamber.</li><li>3. Ensure complete coagulant mix with water.</li></ol>

### 10.2 Technical and Customer Assistance

If for any reason assistance is needed regarding this instrument please do not hesitate to contact either the HF scientific, inc. Service Department or the HF scientific, inc. Customer Service Department.

## 11.0 Accessories and Replacement Parts List

The items shown below are recommended accessories and replacement parts.

Accessory	Catalog Number
Cleaning and Descaling Solution	19402
RS-485 Interface Kit	19851
RS-232 Interface Kit	19861
Flow Alarm	19886
Calibration Kit	19922
Interconnect Cable 7.6 meter (25 Ft.)	22480
Operating & Maintenance Manual	21648

To order any accessory or replacement part, please contact the HF scientific, inc. Customer Service Department. If for any reason technical assistance is needed regarding this instrument, please do not hesitate to contact the HF Service Department.

HF scientific, inc.  
3170 Metro Parkway  
Fort Myers, Florida 33916-7597  
Phone: (239) 337-2116  
Fax: (239) 332-7643  
Email: [info@hfscientific.com](mailto:info@hfscientific.com)  
[www.hfscientific.com](http://www.hfscientific.com)

## 12.0 Definitions

<b>Anionic:</b>	Negative charged ions.
<b>Automatic Control:</b>	Placing the control of the dosing pumps under the control of the Streaming current monitor. The Optional PI controller is recommended.
<b>Brownian Motion:</b>	A phenomenon which occurs when microscopic particles are suspended in a solution due to their random bombardment by the fast movement of water molecules.
<b>Cationic:</b>	Positive charged ions.
<b>ICu:</b>	Ion Charge unit. 1 ICu is approximately equal to 1 mA of charge. 1 ICu = 1 SCU.
<b>Ion Charge Analyzer:</b>	Another name for a Streaming Current Monitor.
<b>PI Control:</b>	Proportional Integral Control .A process control algorithm that allows for a faster, tighter control.
<b>PID Control:</b>	Proportional Integral Differential Control. A higher level control algorithm than PI control, but not required in Streaming Current applications.
<b>Silt:</b>	A collective of finely divided clay particles and organic matter suspended in water.
<b>Zeta Potential:</b>	The charge potential required to induce particle mobility when placed under the influence of an electric current.
<b>SCU:</b>	Steaming current unit. 1 SCU = 1ICu.

### **13.0 Warranty**

HF scientific, inc., as vendor, warrants to the original purchaser of this instrument that it will be free of defects in material and workmanship, in normal use and service, for a period of one year from date of delivery to the original purchaser. HF scientific, inc.'s, obligation under this warranty is limited to replacing, at its factory, the instrument or any part thereof. Parts, which by their nature are normally required to be replaced periodically, consistent with normal maintenance, specifically reagent, desiccant, sensors, electrodes, tubing and fuses are excluded. Also excluded are accessories and supply type items.

Original purchaser is responsible for return of the instruments, or parts thereof, to HF scientific, inc.'s factory. This includes all freight charges incurred in shipping to and from HF scientific, inc.'s factory.

HF scientific, inc. is not responsible for damage to the instrument, or parts thereof, resulting from misuse, environmental corrosion, negligence or accident, or defects resulting from repairs, alterations or installation made by any person or company not authorized by HF scientific, inc.

HF scientific, inc. assumes no liability for consequential damage of any kind, and the original purchaser, by placement of any order for the instrument, or parts thereof, shall be deemed liable for any and all damages incurred by the use or misuse of the instruments, or parts thereof, by the purchaser, its employees, or others, following receipt thereof.

Carefully inspect this product for shipping damage, if damaged, immediately notify the shipping company and arrange an on-site inspection. HF scientific, inc. cannot be responsible for damage in shipment and cannot assist with claims without an on-site inspection of the damage.

This warranty is given expressly and in lieu of all other warranties, expressed or implied. Purchaser agrees that there is no warranty on merchantability and that there are no other warranties, expressed or implied. No agent is authorized to assume for HF scientific, inc. any liability except as set forth above.

HF scientific, inc.  
3170 Metro Parkway  
Fort Myers, Florida 33916-7597  
Phone: (239) 337-2116  
Fax: (239) 332-7643  
Email: info@hfscientific.com  
Website:www.hfscientific.com



