

The LP Steam Thawer is an efficient and popular tool for thawing frozen Fire Hydrants and Service Lines. It uses Liquid Propane Gas to heat the 3 gallon Steam Generator and comes complete with a 30 psi Steam Gauge, Safety Valve, and a Steel Nozzle with a 6 ft. Hose for easy maneuverability. In addition, the LP Steam Thawer thaws frozen Pipes, Meters, and Valves; and also removes frozen Mud from Tools and Equipment without damage

Special Notes:

- A. As with any Industrial Tool, use Safety Glasses, Work Gloves, and Protective Clothing. Make sure that your Personal Protective Equipment is suitable for working with High Temperatures up to (250f +).
- B. Before operating the LP Steam Thawer, make sure that you are properly trained to Operate this device, that every Component is in good working condition, and that all Connections are closed tightly.
- C. The Cylinder Hose (14), Regulator (12), and Burner Valve (15) Connections have Left Hand Threads and are so indicated by Notches on the Coupling Nuts. Tighten by turning Counter-clockwise and Loosen by turning Clockwise.
- D. The Steam Hose (5) Connections have Standard Right Hand Threads.
- E. The Steam Hose and Nozzle (4) are always fully open, so the Generator Gauge (6) will NOT indicate Steam Pressure unless the Nozzle is clogged or held against a solid object restricting flow. If this type of restriction occurs, the Pressure Relief Valve (9) will automatically open at 10 psi.

Operating Instructions for the LP Steam Thawer

1. Remove Filler Cap (8) and fill Generator (2) with water until the Sight Glass Tube (7) reads full, which will provide approximately 40 minutes of steam generation.
2. Attach the Regulator (12) to the LP Gas Tank (11) and connect the Gas Tank Hose (14) to the Regulator and Burner Valve (15) making sure that all connections are tight.
3. Make sure that the Burner Valve (15) is fully CLOSED and then slowly OPEN the Gas Tank (11) Valve.
4. Slowly OPEN the Burner Valve (15) and listen for a slight 'hissing' sound indicating that Gas is flowing, then using the MP-1 Lighter (16) ignite the Burner through the Large Hole in the Shell (1). If no hissing sound is heard make sure that the Regulator (12) is slightly opened, and then make sure the Gas Tank is not empty.

ADJUSTING GAS REGULATOR: Loosen the Jam Nut and turn the Tee Handle Clockwise to INCREASE flow, or turn Counter-clockwise to DECREASE the rate of flow. Always tighten the Jam Nut after making adjustments so that the rate of flow remains constant.

Operating Instructions for the LP Steam Thawer (cont.)

5. Adjust the Regulator (12) so that the Gauge (13) reads 5 psi of Gas Pressure.
6. Control the Burner Flame using the Burner Valve (15) by turning Counter-clockwise for a Higher Flame and Clockwise for a Lower Flame. DO NOT adjust the Flame with the Gas Regulator (12).
7. IMPORTANT! To shut down the unit, first Close the Gas Tank (11) Valve and when the Flame expires, Close the Burner Valve (15).
8. Always Drain the Generator (2) water before storing the unit to prevent corrosion of internal components. Drain the Sight Glass Tube (7) by Opening the Lower Valve of the Valve Assembly (10).

Other Instructions

- A. NEVER leave an empty Generator (2) over the Flame.
- B. NEVER open the Filler Cap (8) if the Generator Gauge (6) indicates Steam Pressure.
- C. NEVER fill the Generator (2) while in operation. Remove the Generator from the Shell (1) to refill the Generator.



PRODUCT DATA SHEET

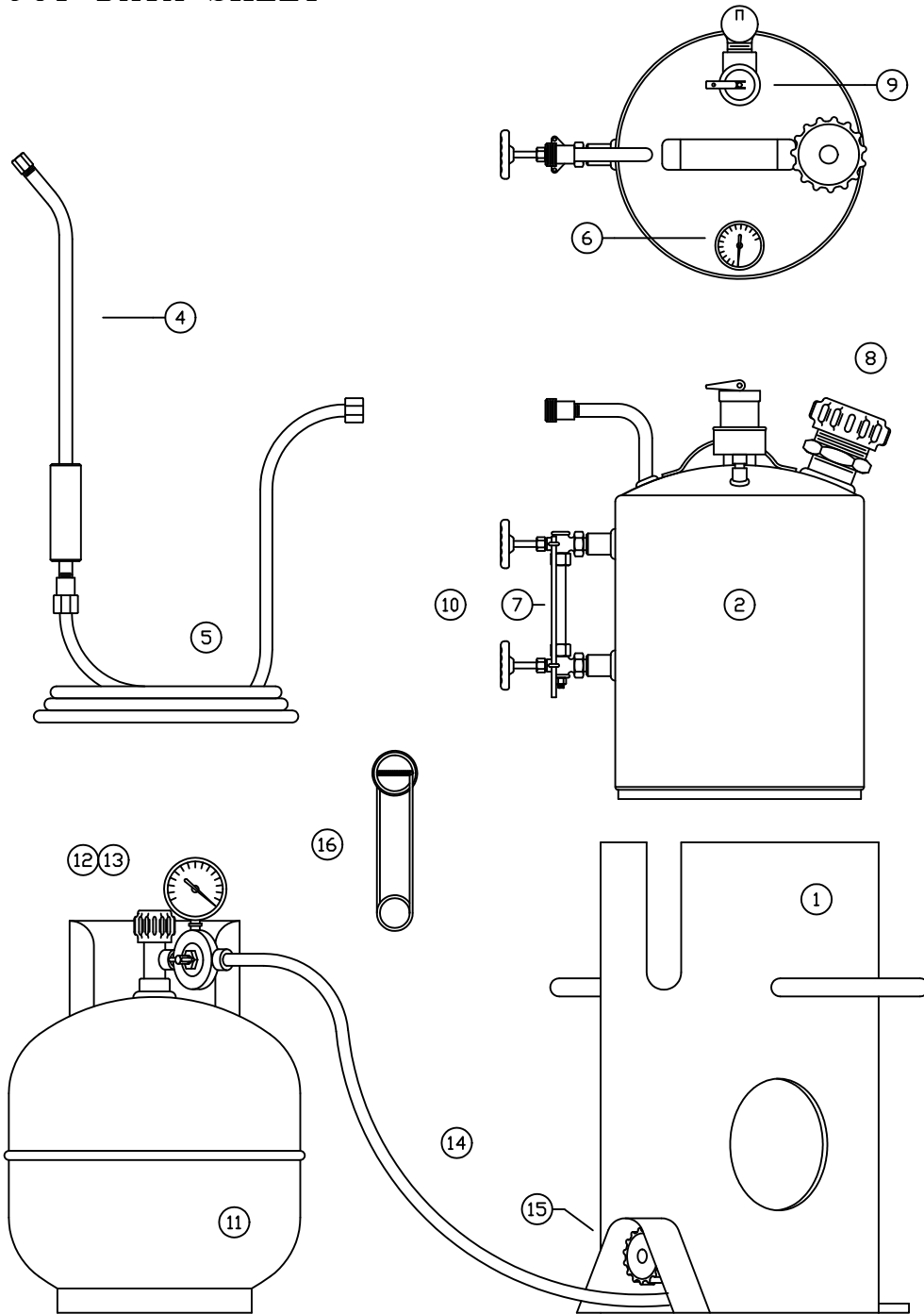

1	Shell	P68301
2	Generator	P68302
4	Nozzle	P68304
5	Steam Hose - 6 ft.	P68305
6	Generator Gauge	P68306
7	Sight Glass	P68307
8	Filler Cap	P68308
9	Pressure Relief Valve	P68309
10	Complete Valve Assembly	P68310
11	LP Gas Tank	P610
12	Regulator with Gauge	P61002
13	Regulator Gauge	P61014
14	Gas Supply Hose - 6 ft.	P61007
15	Burner Tube and Valve	RAWP683BURNTUBE
16	Lighter	P61006

THIS DRAWING AND ALL INFORMATION THEREON IS THE PROPERTY OF THE JOSEPH G. POLLARD COMPANY AND SHALL NOT BE USED, COPIED, OR REPRODUCED WITHOUT WRITTEN CONSENT. ALL DESIGN AND INVENTION RIGHTS ARE RESERVED.

REV	REVISION DESCRIPTION		DATE	
Pollardwater.com 200 Atlantic Avenue • New Hyde Park, NY 11040				
TITLE P68302 STEAM GENERATOR				
SIZE B	DRAFTSMAN DMB	DATE 09/30/02	APPROVAL	DATE
SCALE NTS			DRAWING NO. JGPS0043	
SUPERSEDES			REV 1	
SHEET			1 OF 1	